

Northwest Middle School Reroof

ADDENDUM NO. 3

TO: All Bidders on the Above Referenced Product
FROM: Davis Purdy Architects, PLLC
DATE: April 28, 2026
SUBJECT: **ADDENDUM NO. 3**

ACKNOWLEDGEMENT OF RECEIPT OF ADDENDUM IS REQUIRED ON BID FORM.

Clarifications and revisions to Contract Documents for the referenced project are as follows:

1. **CLARIFICATION:** Roof slopes and insulation to be as follows. All existing slopes are approximate should be verified in field:

400 Building -

Upper Roof: +/- 3,450 Sq Ft
Existing Deck Slope = 1/4:12
Final slope = 1/4:12
Insulation = non- tapered

Lower Roof: +/- 32,411 Sq Ft
Existing Deck Slope = 1/4:12
Final slope = 1/4:12
Insulation = non-tapered

500 Building -

Roof: +/- 28,402 Sq Ft
Existing Deck Slope = 1/4:12
Final slope = 1/4:12
Insulation = non-tapered

Gymnasium Building -

Upper Roof: +/- 8,414 SQ FT
Existing Deck Slope = 1:12

Final slope = 1:12
Insulation = non-tapered

Lower Roof 1: +/- 10,694 SQ FT
Existing Deck Slope= 1/8:12
Final slope = 1/4:12
Insulation = 1/8" tapered

Lower Roof 2: +/- 647 SQ FT
Existing Deck Slope = 1/8:12
Final slope = 1/4:12
Insulation =1/8" tapered

300 Building -

Upper Roof: +/- 9,647 Sq Ft
Existing Deck Slope = 0:12
Final slope = 1/4:12
Insulation = 1/4" tapered

Lower Roof: +/- 10,170 Sq Ft
Existing Deck Slope = 1/4:12
Final slope = 1/4:12
Insulation = 1/4" tapered

2. **CLARIFICATION:** Non water-based adhesive is permissible on this project.

3. **REPLACE:** Drawing **D101 - DEMOLITION PLAN - 400 BUILDING** dated 3/26/26 with Drawing **D101 - DEMOLITION PLAN - 400 BUILDING** dated 4/28/26. Drawing D101 is attached.

4. **REPLACE:** Drawing **D102 - DEMOLITION PLAN - 500 BUILDING** dated 3/26/26 with Drawing **D102 - DEMOLITION PLAN - 500 BUILDING** dated 4/28/26. Drawing D102 is attached.

5. **REPLACE:** Drawing **D103 - DEMOLITION PLAN - GYMNASIUM BUILDING** dated 3/26/26 with Drawing **D103 - DEMOLITION PLAN - GYMNASIUM BUILDING** dated 4/28/26. Drawing D103 is attached.

6. **REPLACE:** Drawing **D104 - DEMOLITION PLAN - 300 BUILDING** dated 3/26/26 with Drawing **D104 - DEMOLITION PLAN - 300 BUILDING** dated 4/28/26. Drawing D104 is attached.

7. **REPLACE:** Drawing **A103 - ROOF PLAN - GYMNASIUM BUILDING** dated 3/26/26 with Drawing **A103 - ROOF PLAN - GYMNASIUM BUILDING** dated 4/28/26. Drawing A103 is attached.

8. **REPLACE:** Drawing **A104 - ROOF PLAN - 300 BUILDING** dated 3/26/26 with Drawing **A104 - ROOF PLAN - 300 BUILDING** dated 4/28/26. Drawing A104 is attached.

Submitted By



Mark Davis, AIA

Davis Purdy Architects, PLLC

April 28, 2026



**ACKNOWLEDGEMENT OF RECEIPT OF THIS ADDENDUM IS
REQUIRED AND SHALL BE INDICATED ON BID FORM**



DAVIS PURDY ARCHITECTS, PLLC
 2011 23rd Avenue
 Meridian, Mississippi 39301
 P: 601.282.1655
 E: info@davispurdyarchitects.com
 W: www.davispurdyarchitects.com

This drawing is the property of DAVIS PURDY ARCHITECTS, PLLC and it not to be reproduced or copied in whole or in part. It is to be used for the project and site specifically identified herein and is not to be used on any other project. It is to be returned upon request.
 © DAVIS PURDY ARCHITECTS, PLLC

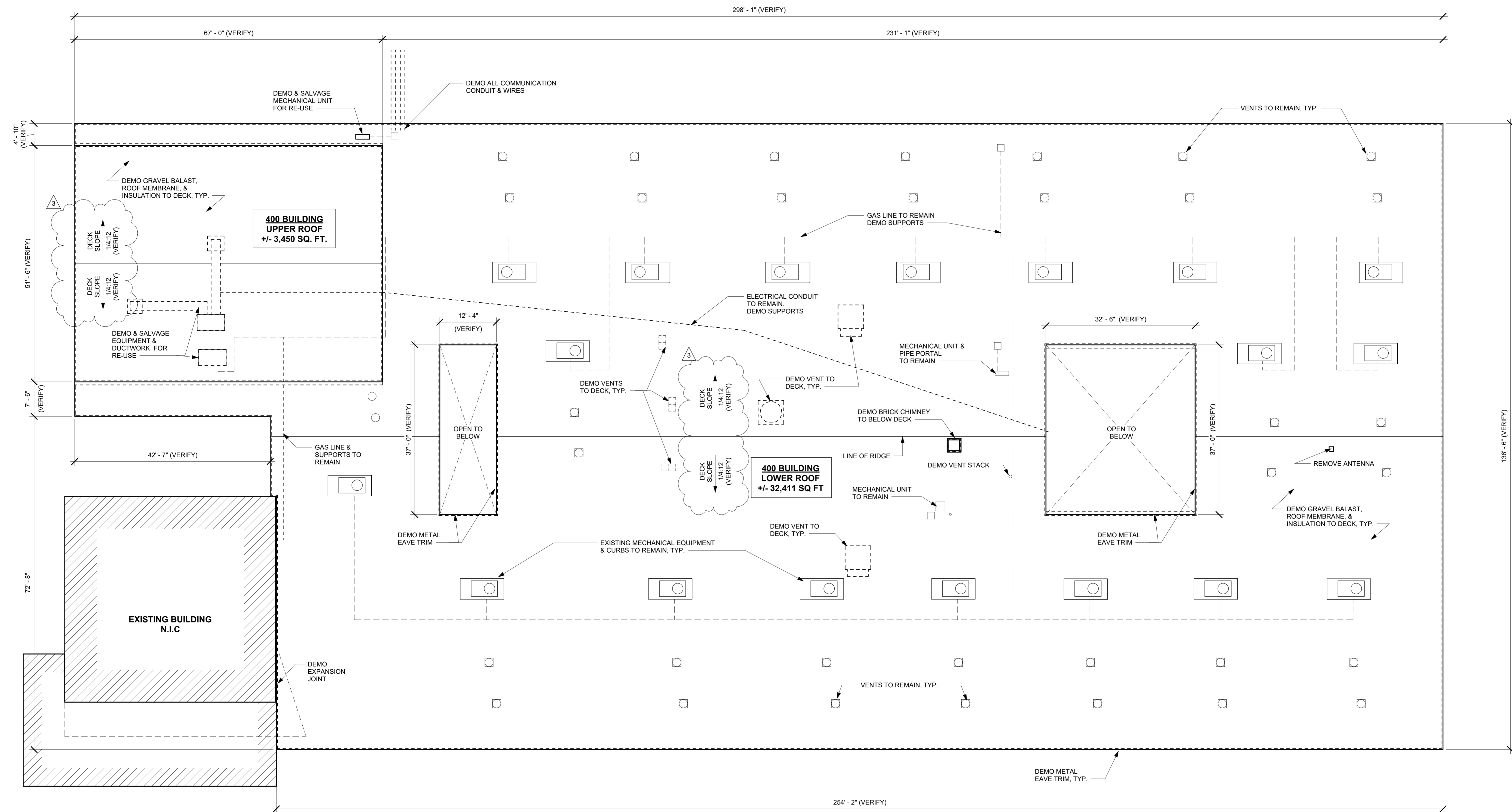

① DEMOLITION PLAN - 400 BUILDING
 3/32" = 1'-0"

- ROOF DEMOLITION GENERAL NOTES:**
1. REMOVE ALL ROOFING AND INSULATION TO DECK
 2. REMOVE ALL VENTS ABOVE DECK
 3. REMOVE ALL GUTTERS AND DOWNSPOUTS

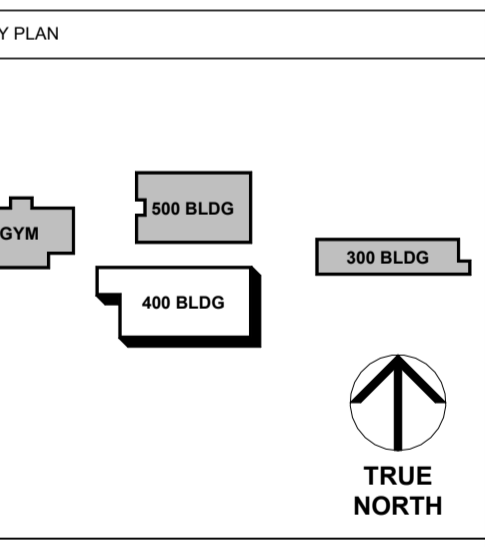

No.	Description	Date
1	SCHEMATIC DESIGN	2/26/26
2	DESIGN REVIEW SET	3/5/26
3	CONSTRUCTION DOCS	3/26/26
4	ADDENDUM #3	4/28/26

NORTHWEST MIDDLE SCHOOL REROOF

4400 32nd Street, Meridian, MS 39307

DEMOLITION PLAN - 400 BUILDING

Project No. 25-014 Date 4/28/26

D101



DAVIS PURDY ARCHITECTS, PLLC
 2011 23rd Avenue
 Meridian, Mississippi 39301
 P: 601.282.1655
 E: info@davispurdyarchitects.com
 W: www.davispurdyarchitects.com

This drawing is the property of DAVIS PURDY ARCHITECTS, PLLC and is not to be reproduced or copied in whole or in part. It is to be used for the project and site specifically identified herein and is not to be used on any other project. It is to be returned upon request.

© DAVIS PURDY ARCHITECTS, PLLC

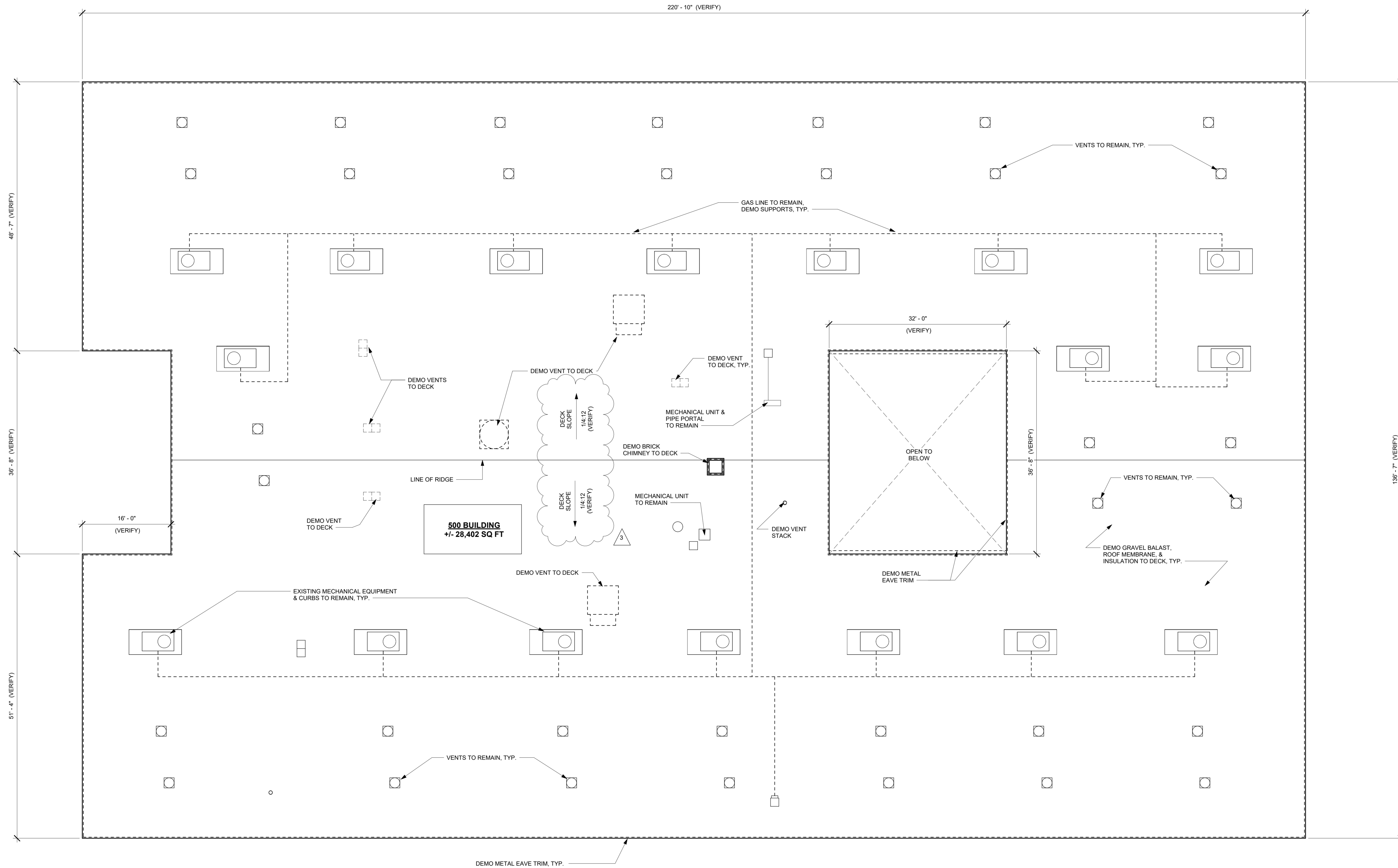

KEY PLAN

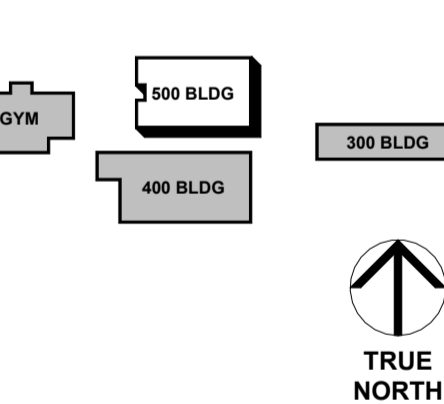

Scale



No.	Description	Date
1	SCHEMATIC DESIGN	2/26/26
2	DESIGN REVIEW SET	3/5/26
3	CONSTRUCTION DOCS	3/26/26
4	ADDENDUM #3	4/28/26

NORTHWEST MIDDLE SCHOOL REROOF

4400 32nd Street, Meridian, MS 39307

DEMOLITION PLAN - 500 BUILDING

Project No. 25-014 Date 4/28/26

D102

ROOF DEMOLITION GENERAL NOTES:
 1. REMOVE ALL ROOFING AND INSULATION TO DECK
 2. REMOVE ALL VENTS ABOVE DECK
 3. REMOVE ALL GUTTERS AND DOWNSPOUTS

1 DEMOLITION PLAN - 500 BUILDING
 1/8" = 1'-0"

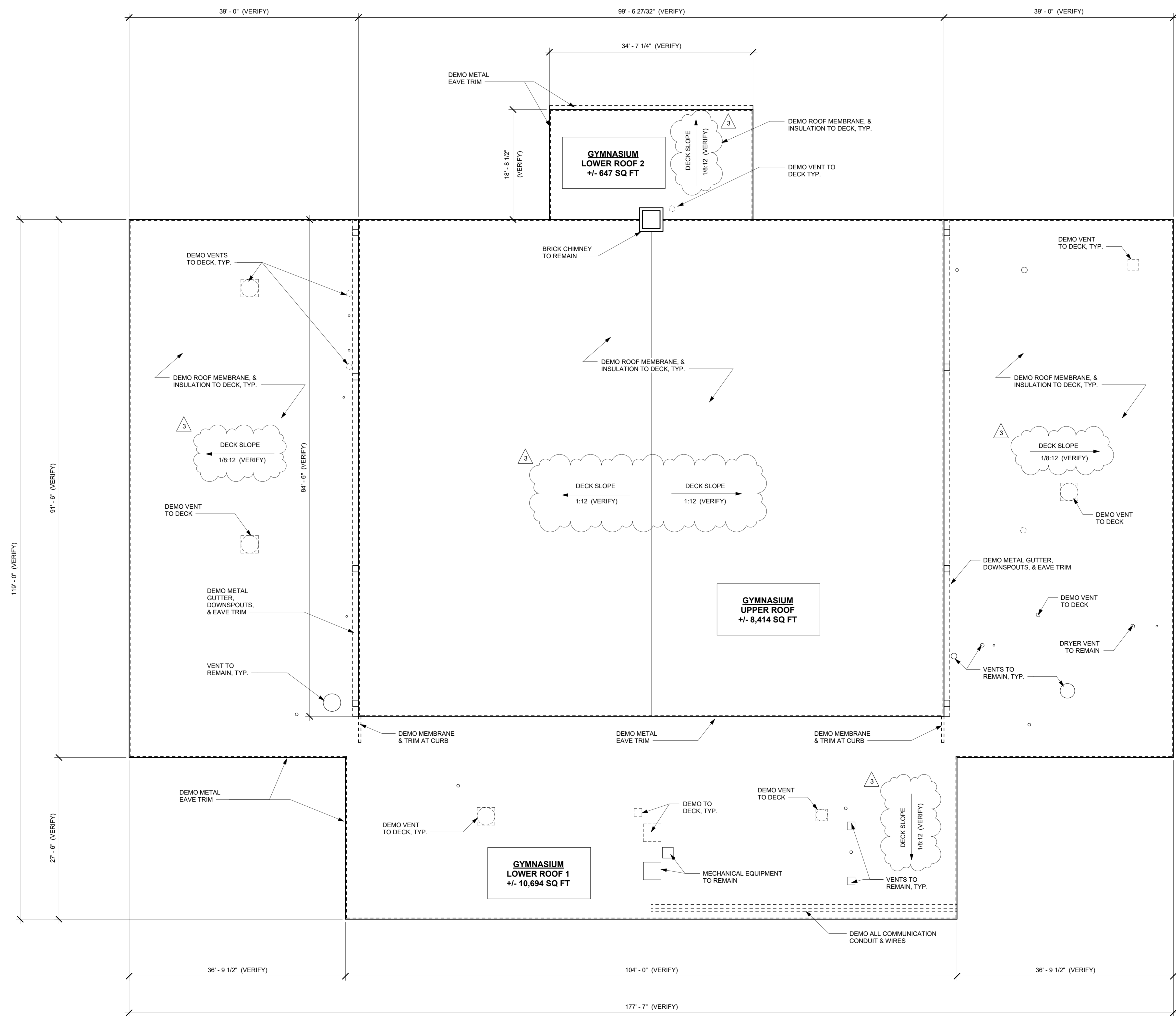

DEMOLITION PLAN - GYMNASIUM BUILDING
 1/8" = 1'-0"

ALTERNATE #1 - OMIT ALL WORK ON GYMNASIUM BUILDING

- ROOF DEMOLITION GENERAL NOTES:**
1. REMOVE ALL ROOFING AND INSULATION TO DECK
 2. REMOVE ALL VENTS ABOVE DECK
 3. REMOVE ALL GUTTERS AND DOWNSPOUTS

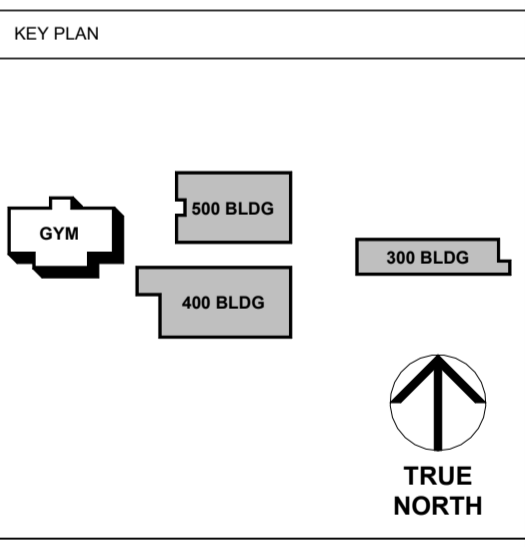

No.	Description	Date
1	SCHEMATIC DESIGN	2/26/26
2	DESIGN REVIEW SET	3/5/26
3	CONSTRUCTION DOCS	3/26/26
4	ADDENDUM #3	4/28/26

NORTHWEST MIDDLE SCHOOL REROOF

4400 32nd Street, Meridian, MS 39307

DEMOLITION PLAN - GYMNASIUM BUILDING

Project No. 25-014 Date 4/28/26

D103



DAVIS PURDY ARCHITECTS, PLLC
 2011 23rd Avenue
 Meridian, Mississippi 39301
 P: 601.282.1655
 E: info@davispurdyarchitects.com
 W: www.davispurdyarchitects.com

This drawing is the property of DAVIS PURDY ARCHITECTS, PLLC and is not to be reproduced or copied in whole or in part. It is to be used for the project and site specifically identified herein and is not to be used on any other project. It is to be returned upon request.

© DAVIS PURDY ARCHITECTS, PLLC

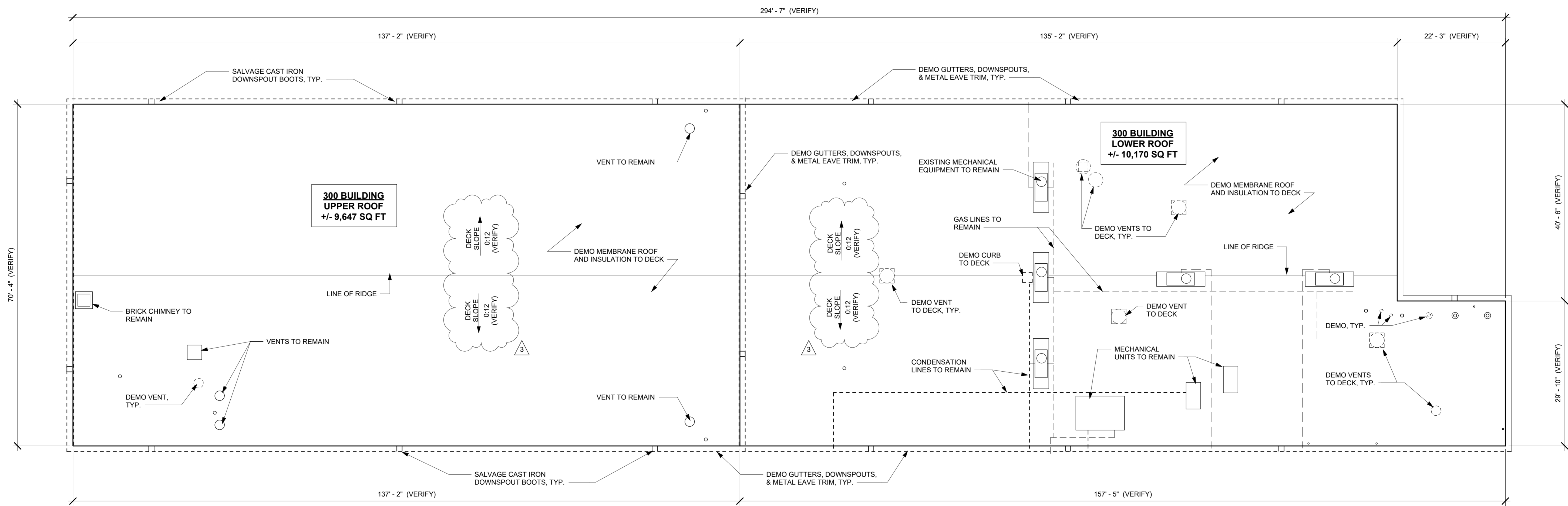

ALTERNATE #2 - OMIT ALL WORK ON 300 BUILDING

ROOF DEMOLITION GENERAL NOTES:
 1. REMOVE ALL ROOFING AND INSULATION TO DECK
 2. REMOVE ALL VENTS ABOVE DECK
 3. REMOVE ALL GUTTERS AND DOWNSPOUTS

1 DEMOLITION PLAN - 300 BUILDING
 3/32" = 1'-0"

KEY PLAN

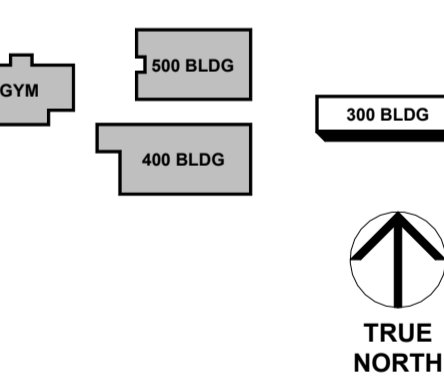

Scale



No.	Description	Date
1	SCHEMATIC DESIGN	2/26/26
2	DESIGN REVIEW SET	3/5/26
3	CONSTRUCTION DOCS	3/26/26
4	ADDENDUM #3	4/28/26

NORTHWEST MIDDLE SCHOOL REROOF

4400 32nd Street, Meridian, MS 39307

Sheet Title
 DEMOLITION PLAN - 300 BUILDING

Project No. 25-014 Date 4/28/26

D104

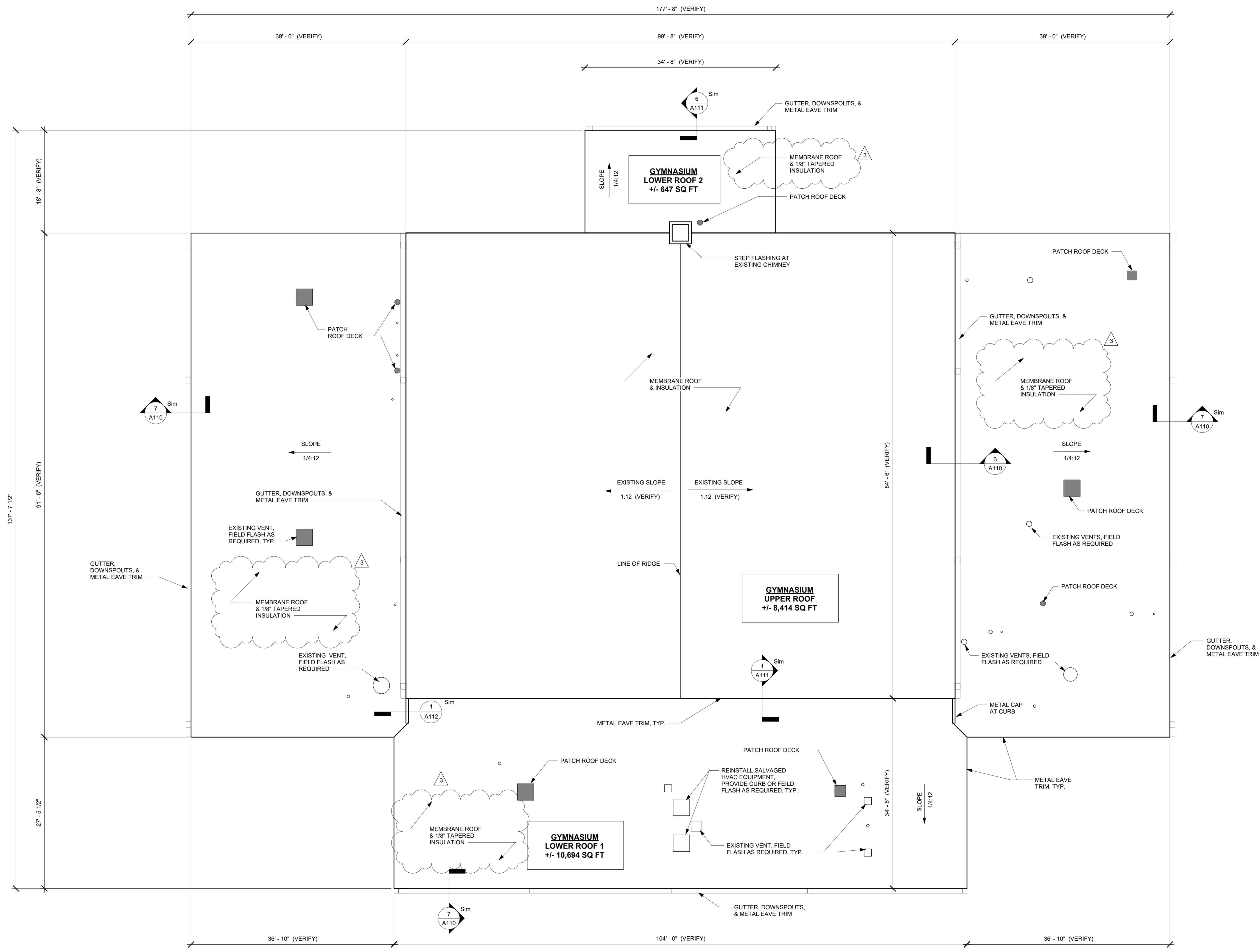

ALTERNATE #1 - OMIT ALL WORK ON GYMNASIUM BUILDING

- GENERAL NOTES:**
1. RIGID INSULATION TO BE MINIMUM R30
 2. PROVIDE FLASHING AT ALL EXISTING ROOF PENETRATIONS PER TYPICAL ROOF DETAILS
 3. FIELD WRAP ALL EXISTING PIPE VENTS NOT SHOWN ON DRAWINGS
 4. PROVIDE & INSTALL CONCRETE SPLASH BLOCK AT ALL DOWNSPOUTS
 5. FILL OPENINGS IN TECTUM DECK W/ MATCHING MATERIAL & PAINT TO MATCH CEILING WHERE EXPOSED
 6. REMOVE AND REPLACE DAMAGED TECTUM DECK W/ MATCHING MATERIAL & PAINT TO MATCH CEILING WHERE EXPOSED
 7. CONTRACTOR IS RESPONSIBLE FOR THE REPAIR OR REPLACEMENT OF ANY ROOFING EQUIPMENT DAMAGED IN THE DEMOLITION OR CONSTRUCTION PROCESS

1 ROOF PLAN - GYMNASIUM BUILDING
 1/8" = 1'-0"

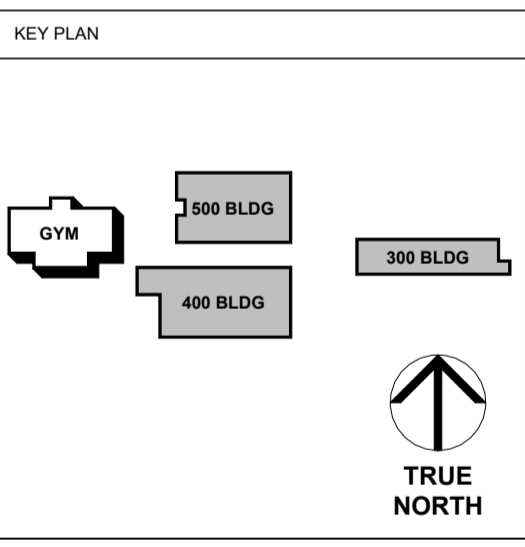

No.	Description	Date
1	SCHEMATIC DESIGN	2/26/26
2	DESIGN REVIEW SET	3/5/26
3	CONSTRUCTION DOCS	3/26/26
4	ADDENDUM #3	4/28/26

NORTHWEST MIDDLE SCHOOL REROOF

4400 32nd Street, Meridian, MS 39307

ROOF PLAN - GYMNASIUM BUILDING

Project No. 25-014 Date 4/28/26

A103



DAVIS PURDY ARCHITECTS, PLLC
 2011 23rd Avenue
 Meridian, Mississippi 39301
 P: 601.282.1655
 E: info@davispurdyarchitects.com
 W: www.davispurdyarchitects.com

This drawing is the property of DAVIS PURDY ARCHITECTS, PLLC and is not to be reproduced or copied in whole or in part. It is to be used for the project and site specifically identified herein and is not to be used on any other project. It is to be returned upon request.

© DAVIS PURDY ARCHITECTS, PLLC

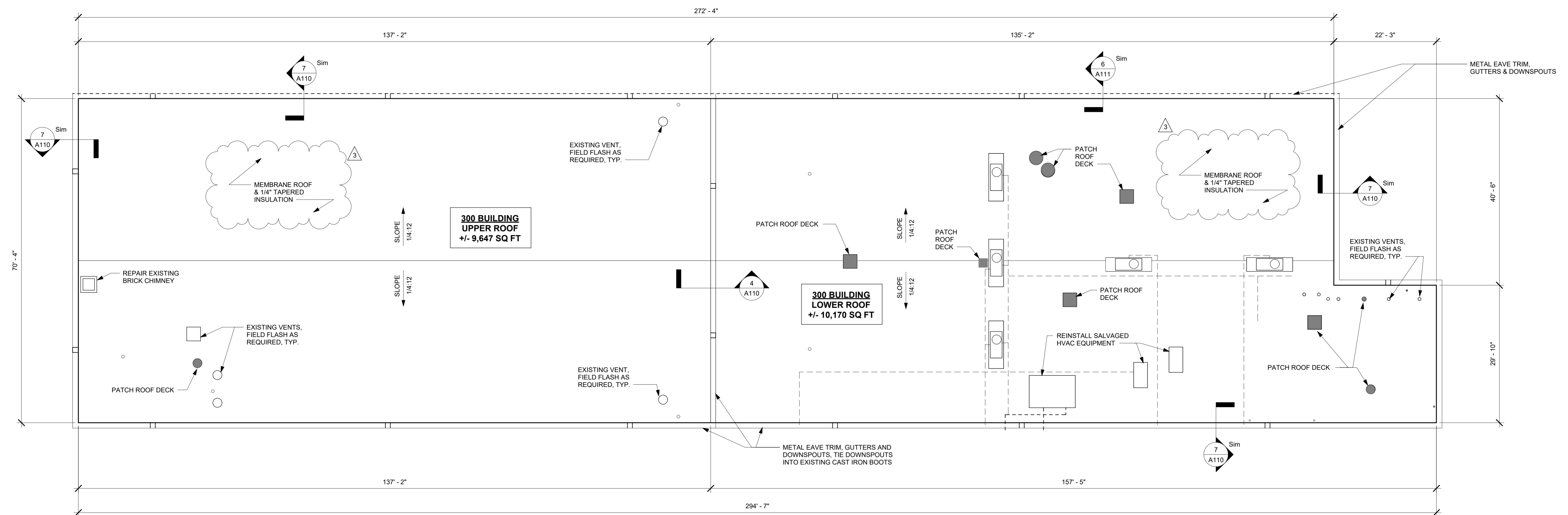

ALTERNATE #2 - OMIT ALL WORK ON 300 BUILDING

1 ROOF PLAN - 300 BUILDING
 3/32" = 1'-0"

KEY PLAN

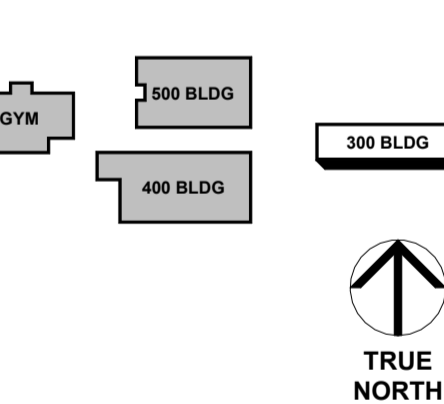

Scale



No.	Description	Date
1	SCHEMATIC DESIGN	2/26/26
2	DESIGN REVIEW SET	3/5/26
3	CONSTRUCTION DOCS	3/26/26
4	ADDENDUM #3	4/28/26

NORTHWEST MIDDLE SCHOOL REROOF

4400 32nd Street, Meridian, MS 39307

Sheet Title
 ROOF PLAN - 300 BUILDING

Project No. 25-014 Date 4/28/26

A104