

**Cancer Treatment Center 2022
South Central Regional Medical Center
Laurel, MS**

**From: Foil Wyatt Architects & Planners, PLLC
1510 North State Street, Suite 200
Jackson, MS 39202**

Addendum No. 3
October 6, 2022

This addendum forms a part of the contract documents and modifies the original plans and specifications dated June 10, 2022.

Drawings:

Item 3.1: Sheet C-100, C-101

Note: See Sheet AD03a which clarifies site paving.

Item 3.2: Sheet D-101

Replace: Note 6 with "Remove all finish floor & base, including mastic, setting bed and/or thin set to accept new level flooring."

Replace: Note 13 with "Remove exist. sink and water closet. Temporarily cap all utilities for re-use. Remove all floor and wall tile to accept new tile finish."

Replace: Note 14 with "Remove exist. toilet partitions."

Item 3.3: Sheet I-101, Sheet A-703, Sheet A-705

Remove: Sheet I-101 Note under exist. Toilet Rooms legend "~~Exist. floor to remain~~".

Replace: Sheet I-101 Note under Exist. Corridor legend "~~Patch to match existing~~" with "Replace with a standard VCT. Accent color to be selected by Architect."

Remove: Notes "~~Existing C.T. Repair as req. due to demo.~~" from detail 8/A-703, 3/A-705, and 4/A-705.

Note: Existing Toilet Rooms 1037, 1038, 1061, & 1062 shall receive PT01, P.B.T., & P.W.T in lieu of repairing tile finish as required. See sheet I-101 for material selection.

Note: See Sheet AD03b which adds a \$5,000 Allowance and clarifies flooring as described.

Item 3.4: Sheet A-503 Detail 9, Sheet A-703 Details 2 & 7, Sheet A-704 Details 1, 2, 3, & 4, Sheet A-705 Detail 1

Note: All 2x2 Steel Tube supports are 36" tall and occur in both Treatment Bays called out in the Interior Elevations. See sheets AD03c and AD03d for locations highlighted.

Item 3.5: Sheet A-101B

Replace: Elevation tag reference "3/A701" to read "1/A-705".

End of Addendum No. 3

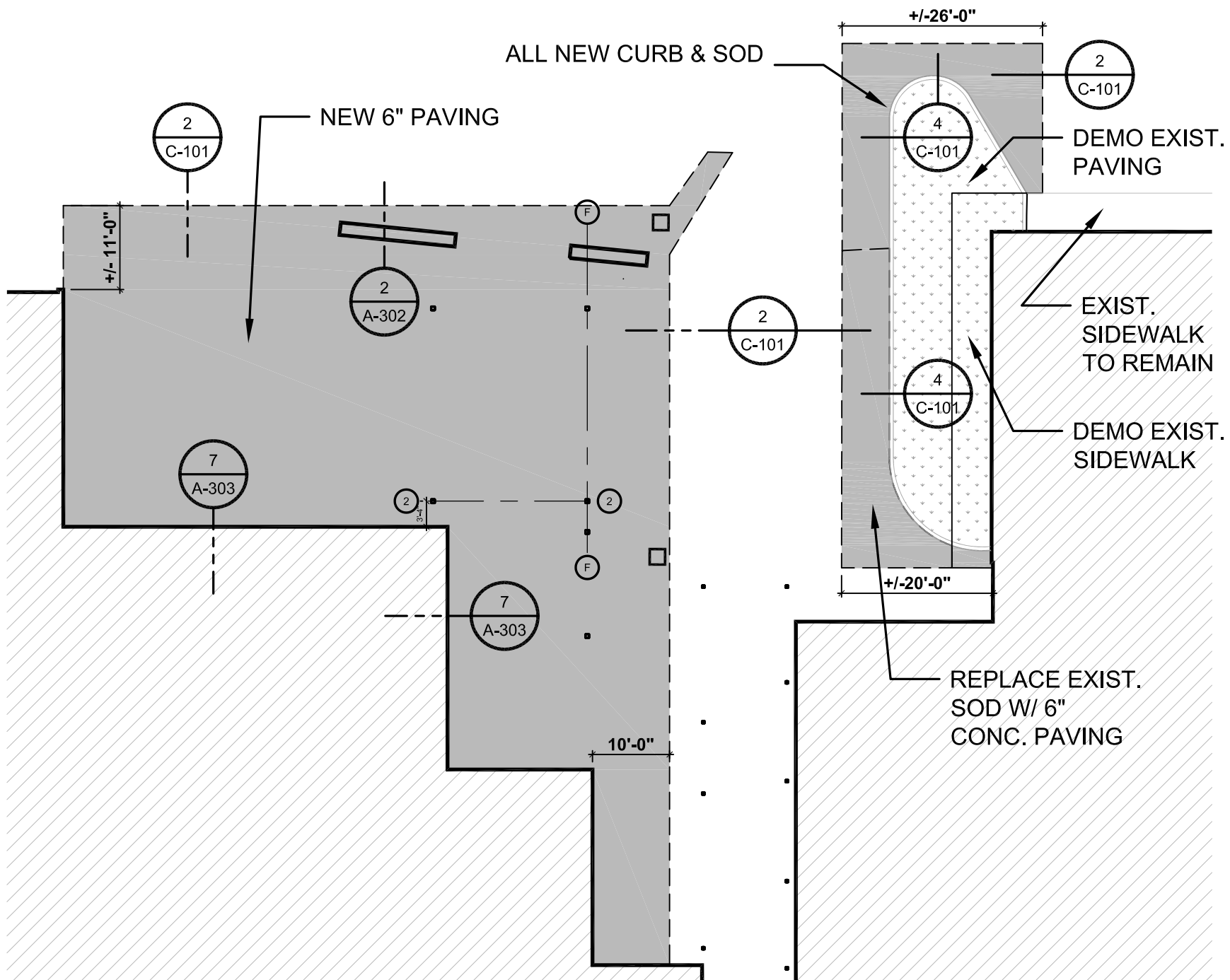

FoellWatt

Architecture & Planning, PLLC
 SUITE 400
 1500 NORTH STATE STREET
 JACKSON, MS 39201
 TELEPHONE: (601) 532-5971
 FAX: (601) 532-5978
 EMAIL: info@foellwatt.com

NEW CANCER TREATMENT CENTER
 SOUTH CENTRAL REGIONAL MEDICAL CENTER

MISSISSIPPI

LAUREL

project no.
 1608-19

date

OCT. 6, 2022

AD03a

SITE PAVING
 CLARIFICATION

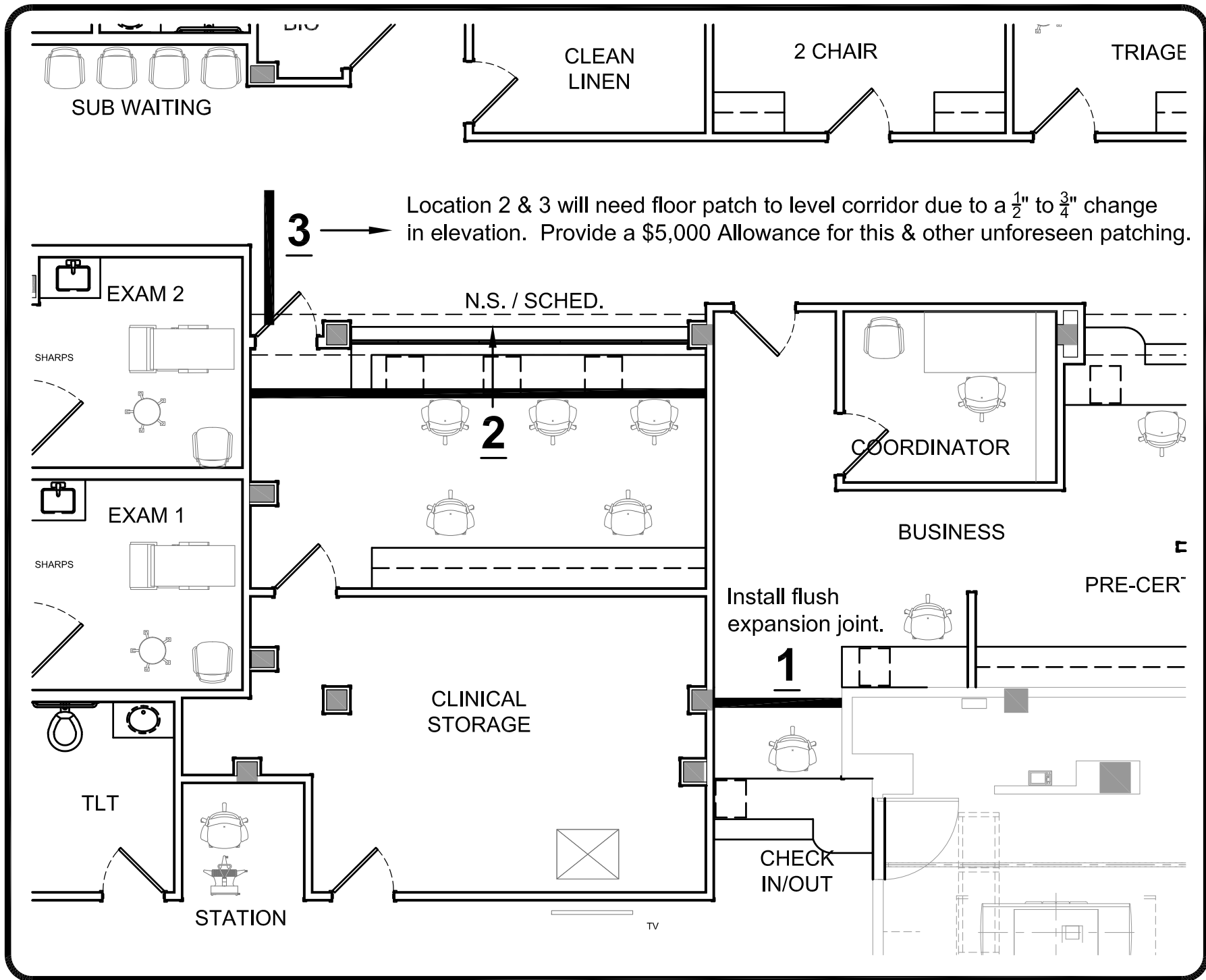

FoileWatt

Architecture & Planners, PLLC
 1310 NORTH STATE STREET
 SUITE 400
 JACKSON, MISSISSIPPI 39201
 TELEPHONE: 601-552-9771
 FAX: 601-552-9778
 EMAIL: info@foilewatt.com

NEW CANCER TREATMENT CENTER
SOUTH CENTRAL REGIONAL MEDICAL CENTER

MISSISSIPPI

LAUREL

project no.
 1608-19

date

OCT. 6, 2022

AD03b

FLOORING
 CLARIFICATION

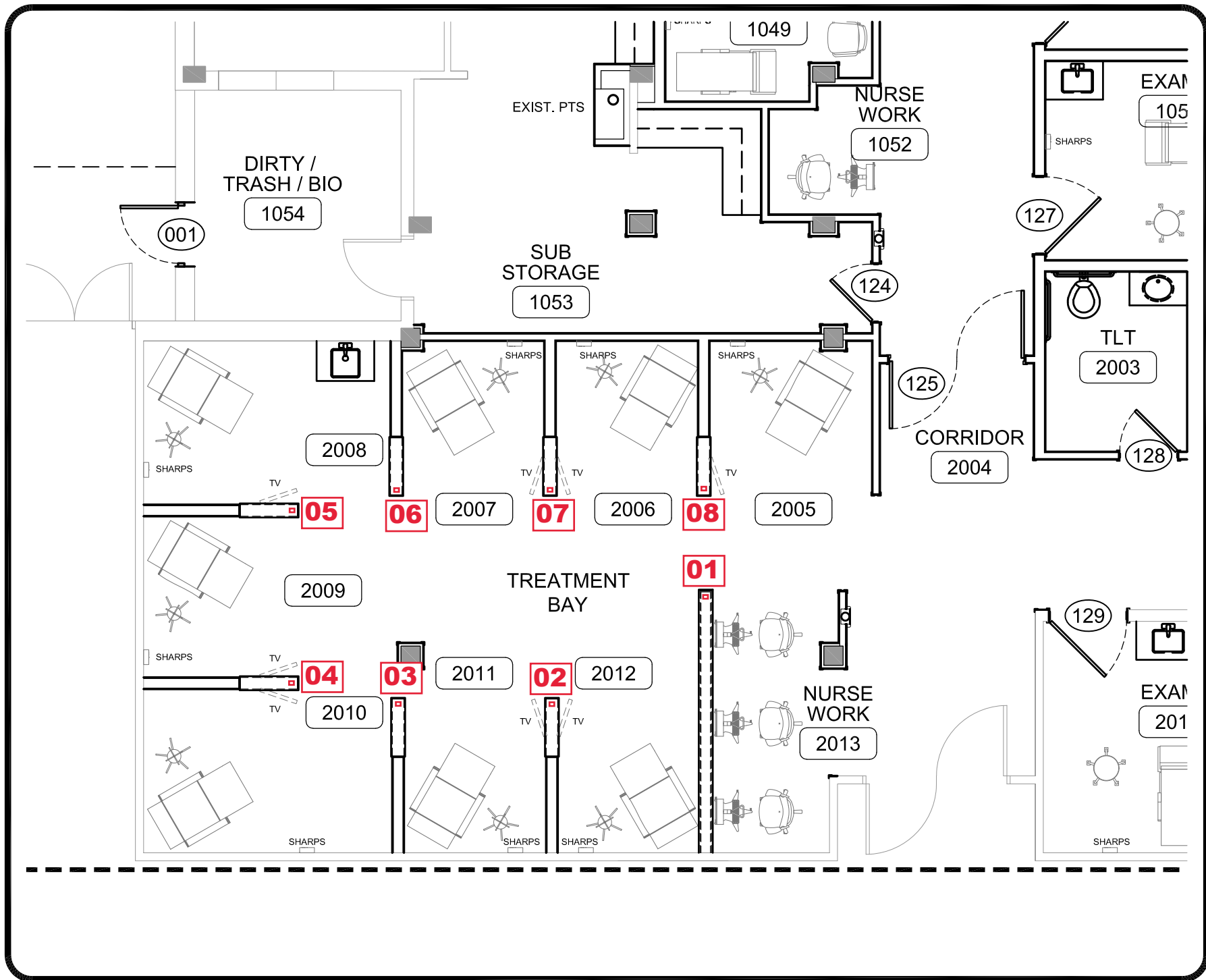

FoillWatt

Architecture & Planning, PLLC
 1300 NORTH STATE STREET
 SUITE 400
 LAUREL, MISSISSIPPI 39042
 TELEPHONE: 601-533-9771
 FAX: 601-533-9778
 EMAIL: info@foillwatt.com

NEW CANCER TREATMENT CENTER
SOUTH CENTRAL REGIONAL MEDICAL CENTER

MISSISSIPPI

LAUREL

project no.
 1608-19

date

OCT. 3, 2022

AD03d
 STEEL TUBE
 CLARIFICATION

8 TOTAL 2X2 ENDWALL SUPPORTS AT 36" TALL. SEE ABOVE HIGHLIGHTED AREAS FOR LOCATIONS IN THIS TREATMENT BAY.