

May 13, 2024

ADDENDUM NUMBER THREE (3)

Project: Health Sciences Complex (Rankin Campus)  
Hinds Community College  
Pearl, MS  
HCC Bid #3298  
PN: 21041

FROM: Dean Architecture, P.A.  
661 Sunnybrook Road, Suite 140  
Ridgeland, MS 39157  
(601) 939-7717

The following additions, changes, clarifications and/or substitutions to the Project Drawings and Project Manual as indicated, are hereby made a part of the Contract Documents. Acknowledge receipt of this Addendum by inserting its number and date in the Proposal Form where indicated.

General:

- Item #1:** Spray Foam Insulation is not required on this project. Spray Fireproofing is required per life safety plans and details.
- Item #2:** Note: Contractors are advised to read the ceiling height note on the Ceiling Legend on each sheet." All Ceilings to be 9'-0" A.F.F. unless noted otherwise" - Ceiling Details are noted accordingly. Typical details are shown for 10' ceilings and typical details are shown for 9' ceilings.
- Item #3:** Contractors / construction workers passenger vehicles can utilize the first two bays of the existing parking lot just South of the construction site. The GC must coordinate this use with the Owner as events at the Muse Center often require use of the entire parking lot area. The GC shall photo document the existing condition of this parking lot and repair / fix the area back to its pre-use condition at the conclusion of the project. The GC shall keep the area clean of all trash and construction materials.
- Item #4:** The GC is allowed to use the vacant lot to the East of the construction site across College Blvd. for construction laydown and material storage. The GC shall photo document the existing condition of this lot and repair /regrade the area back to its pre-use condition at the conclusion of construction. The GC shall keep the area clean of all trash and debris.
- Item #5:** Digital Submittals and Close Out Documents are preferred for this project. This will be further clarified in the pre-construction conference to denote method and proper address for electronic / digital submittals.

Refer to Drawings:

- Item #1:** Sheet A401 – Enlarged Stair Plans and Section – Detail 5.

Remove note calling for Spray Foam Insulation at lower level and replace with the following:  
Spray Fireproofing required on all Steel beams, joist, and decking – See Life Safety Plans.

**Item #2:** Sheet 402 – Enlarged Stair Plans and Section – Detail 5

Remove note calling for Spray Foam Insulation and replace with the following:  
Spray Fireproofing required on all Steel beams, joist, and decking – See Life Safety plans.

**Item #3:** Sheet A900 – Finish Legend and Notes

Remove existing sheet and replace with revised Sheet A900 dated 5/13/2024.  
Revised Tile and Quartz Selections.

**Item #4:** Sheet A901A – First Floor Finish Plan - Part “A”

Remove existing sheet and replace with revised Sheet A901A dated 5/13/2024.  
Added accent paint locations.

Refer To Specifications:

**Item #1:** Section 095100 – Acoustical Ceilings – Paragraph 1.90 Extra Materials

Change 5 percent to read 2 percent of extra Acoustical Tile.

CIVIL

SEE ATTACHED CIVIL ITEMS PROVIDED BY McMASTER & ASSOCIATES INC.

STRUCTURAL

SEE ATTACHED STRUCTURAL ITEMS PROVIDED BY SPENCER ENGINEERS

MECHANICAL

SEE ATTACHED MECHANICAL ITEMS PROVIDED BY ERG

ELECTRICAL

SEE ATTACHED ELECTRICAL ITEMS PROVIDED BY THE POWER SOURCE

END OF ADDENDUM NUMBER THREE (3)

Dean Architecture, P.A.

  
Kenneth A. Oubre, AIA, Principal



PLEASE ATTACH THIS ADDENDUM TO THE INSIDE FRONT COVER OF EACH SET OF SPECIFICATIONS.

# FINISH LEGEND

FLOORS:	WALLS:	WT - WALL TILE	MILLWORK
<p>LVT - LUXURY VINYL TILE</p> <p>LVT1 - LOBBY MANUFACTURER: PATCRAFT SERIES: ADMIX SIZE: 36" X 36" COLORS: A: LIGHTEST - TO BE SELECTED B: MIDTONE - TO BE SELECTED C: DARKEST - TO BE SELECTED ACCESSORIES: ADMIX WELD ROD COLOR: GRAY</p> <p>LVT2 - GENERAL MANUFACTURER: MANNINGTON SERIES: COLOR ANCHOR GROOVE SIZE: 12" X 24", 18" X 18", 6" X 36" 20 MIL WEAR LAYER COLORS: A: LONDON FOG - FIELD TILE B: CITY MOUSE - DARK ACCENT C: KETTLE STEAM - GREY ACCENT D: WINTER FLEECE - WHITE ACCENT E: RHUBARB PIE OR CUSTOM HINDS BURGUNDY</p> <p>LVT2* - INDICATES WHERE AN LVT2 FLOOR PATTERN WILL BE. FLOOR PATTERN SHEETS TO FOLLOW</p> <p>CONTACT BO BROOKSBANK FOR PROJECT INFO &amp; PRICING BO.BROOKSBANK@MANNINGTON.COM</p> <p>LVT3 - WOOD LOOK MANUFACTURER: MANNINGTON PATTERN: SPACIA WOOD COLOR: MULLED OAK SIZE: 6" X 36" 20 MIL WEAR LAYER CONTACT BO BROOKSBANK FOR PROJECT INFO &amp; PRICING BO.BROOKSBANK@MANNINGTON.COM</p> <p>PFT - PORCELAIN FLOOR TILE</p> <p>PFT1 - RESTROOMS MANUFACTURER: BPI / MILESTONE SERIES: TYCOON / STORM GREY SIZE: 12" X 24" &amp; 24" X 48" SEE FLOOR PATTERN SHEETS FINISH: MATTE GROUT: LATICRETE 78 STERLING SILVER</p> <p>SC - SEALED CONCRETE ALL MEP AREAS</p> <p>CPT - CARPET TILE</p> <p>CPT1 - CONFERENCE MANUFACTURER: PATCRAFT PATTERN: COLOR REVEAL / GARNET INSTALL: STAGGER</p> <p>CPT2 - OFFICES MANUFACTURER: SHAW PATTERN: DAYDREAMER PEPTALK INSTALL: ASHLAR</p> <p>CPT3 - STUDENT AREAS MANUFACTURER: J+J / KINETEX PATTERN: NETWORK COLOR: TO BE SELECTED INSTALL: ASHLAR</p>	<p>P - PAINT</p> <p>P1 - GENERAL MANUFACTURER: SHERWIN WILLIAMS COLOR: AGREEABLE GREY FINISH: EGGSHELL</p> <p>P2 - LIGHTER GRAY MANUFACTURER: SHERWIN WILLIAMS COLOR: CRUSHED ICE FINISH: EGGSHELL</p> <p>P3 - DARKER GRAY MANUFACTURER: SHERWIN WILLIAMS COLOR: TO BE SELECTED FINISH: EGGSHELL</p> <p>P4 - MAROON MANUFACTURER: SHERWIN WILLIAMS COLOR: "HINDS MAROON" FINISH: EGGSHELL *COLOR ON FILE AT LOCAL SW STORE*</p> <p>P5 - BLUE MANUFACTURER: SHERWIN WILLIAMS COLOR: TO BE SELECTED FINISH: EGGSHELL</p> <p>P6 - DARK BRONZE ACCENT MANUFACTURER: SHERWIN WILLIAMS COLOR: URBANE BRONZE FINISH: EGGSHELL</p> <p>P7 - FACULTY LOUNGE BLUE MANUFACTURER: SHERWIN WILLIAMS COLOR: TO BE SELECTED FINISH: EGGSHELL</p> <p>P8 - LAB COLOR MATCH TILE MANUFACTURER: SHERWIN WILLIAMS COLOR: TO BE SELECTED FINISH: EGGSHELL</p> <p>P9 - TRIM MANUFACTURER: SHERWIN WILLIAMS COLOR: AGREEABLE GREY FINISH: SEMI GLOSS</p> <p>P10 - CEILING MANUFACTURER: SHERWIN WILLIAMS COLOR: 50% CRUSHED ICE / 50%CEILING WHITE FINISH: FLAT</p>	<p>WT1 - LOBBY / RESTROOM ENTRANCES MANUFACTURER: MILESTONE / BPI SERIES: TYCOON COLOR: STORM GREY / MATTE SIZE: 24" X 48" GROUT: LATICRETE STERLING SILVER SCHLUTER QUADEC IN LIGHT ANTHRACITE</p> <p>WT2 - RESTROOMS &amp; ACCENTS MANUFACTURER: MILESTONE /BPI PATTERN: JEM / FORTE WHITE SIZE: 12" X 24" FINISH: POLISHED GROUT: LATICRETE 78 STERLING SILVER</p> <p>WT3 - LOBBY ALCOVE MANUFACTURER: DAL TILE SERIES: ECLETTICA PATTERNS COLOR: PURPLE M1A8 SIZE: 15" X 48" GROUT:LATICRETE 78 STERLING SILVER</p> <p>WT4 - 3" X 6" WHITE TILE MANUFACTURER: AMERICAN OLEAN SERIES: COLOR STORY WALL COLOR:ICE WHITE SIZE: 3" X 6" FINISH: MATTE GROUT: LATICRETE 95 MINK SCHLUTER JOLLY IN BRUSHED ALUMINUM</p> <p>WT5 - 3" X 6" BEIGE ACCENT TILE MANUFACTURER: AMERICAN OLEAN SERIES: COLOR STORY WALL COLOR: STABLE SIZE: 3" X 6" FINISH: GLOSSY GROUT: LATICRETE 95 MINK</p> <p>WT6 - ELEVATOR ACCENT MANUFACTURER: TO BE SELECTED COLOR: TO BE SELECTED SIZE: 3" X 12" FINISH: GLOSSY GROUT: LATICRETE</p> <p>TMT - THIN CONCRETE MASONRY TILE TO MATCH EXTERIOR CAST STONE</p>	<p>PL - PLASTIC LAMINATE</p> <p>PL1 - LIGHT WOOD LOOK MANUFACTURER: FORMICA COLOR: PECAN WOODLINE</p> <p>PL2 - DARK WOOD LOOK MANUFACTURER: FORMICA COLOR: FORMAL WALNUT</p> <p>PL3 - MARBLE LOOK COUNTERTOP MANUFACTURER: FORMICA COLOR: NEO CLOUD</p> <p>PL4 - NEUTRAL TEXTURE MANUFACTURER: FORMICA COLOR: MUSLIN FABRIC</p> <p>PL5 - ACCENT COLOR MANUFACTURER: FORMICA COLOR: TBD</p> <p>PL6 - SOLID GRAY MANUFACTURER: FORMICA COLOR: TBD</p> <p>PL7 - SOLID WHITE MANUFACTURER: FORMICA COLOR: TBD</p> <p>QZ - QUARTZ</p> <p>QZ1 - RECEPTION DESKS MANUFACTURER: CAMBRIA COLOR: WHITEHALL</p> <p>SS - SOLID SURFACE</p> <p>SS1 - COUNTERTOPS MANUFACTURER: DURASEIN COLOR: ROYAL CARRERA</p>
<p>BASES:</p> <p>RB - RUBBER BASE</p> <p>RB1 - LOBBY &amp; CORRIDORS MANUFACTURER: JOHNSONITE PROFILE: 4" REVEAL MILLWORK BASE COLOR:</p> <p>RB2 - GENERAL MANUFACTURER: JOHNSONITE PROFILE: 4" COVE BASE COLOR: MOON ROCK</p> <p>RB3 MANUFACTURER: JOHNSONITE PROFILE: 4" COLOR:</p> <p>PBT - PORCELAIN BASE TILE</p> <p>PBT1 - RESTROOMS MANUFACTURER: BPI / MILESTONE SERIES: TYCOON COLOR: STORM GREY SIZES: 3" X 12"</p>	<p>WC - WALLCOVERINGS</p> <p>WC1 - WOOD LOOK - LOBBY STAIR MANUFACTURER: KOROSEAL SERIES: ARBOR COLOR:WALNUT, AMERICAN FC AA9011</p> <p>WC2 - CUSTOM HINDS MANUFACTURER: NATIONAL SOLUTIONS TYPE: VINYL THESE WILL VARY PER LOCATION. PLEASE CONTACT APARK@DEANDEAN.COM FOR IMAGE FILES &amp; INFORMATION</p> <p>WC3 - TACK WALL MANUFACTURER: KOROSEAL TYPE: TAC-WALL COLOR: PEWTER</p> <p>WC4 - CONFERENCE MANUFACTURER: NATIONAL / DENOVO TYPE: VINYL COLOR: MOKARA / WINDRUSH</p> <p>WC5 - CONFERENCE ACCENT MANUFACTURER: NATIONAL / DENOVO TYPE: VINYL COLOR: MOKARA / SILVER CREEK</p>	<p>CEILINGS:</p> <p>MAIN LOBBY WOOD CEILING MANUFACTURER: ARMSTRONG WOODWORKS GRILLE COLOR: ANTIQUE OAK EDGE-BACKER SEE SPECS FOR FURTHER INFO</p> <p>LAT - LAY-IN ACOUSTICAL TILE</p> <p>LAT1 - GENERAL / CORRIDORS MANUFACTURER: ARMSTRONG TYPE: CALLA SIZE: SEE REFLECTED CEILING PLANS COLOR: WHITE EDGE: SQUARE LAY IN GRID: WHITE</p> <p>LAT2 - OFFICES, CONFERENCES AND STUDY ROOMS SOUND BLOCKING MANUFACTURER: ARMSTRONG TYPE: CALLA HIGH CAC SIZE: 24" X 24" COLOR: WHITE EDGE: SQUARE LAY IN GRID: WHITE</p> <p>LAT3 - CLASSROOMS &amp; LABS SOUND ABSORBING MANUFACTURER: ARMSTRONG TYPE: OPTIMA LAY IN SIZE: SEE REFLECTED CEILING PLAN COLOR: WHITE EDGE: SQUARE LAY IN GRID: WHITE</p> <p>LAT4 - ADM LOBBY &amp; CONFERENCE SOUND ABSORBING W/ TEGULAR EDGE MANUFACTURER: ARMSTRONG TYPE: OPTIMA TEGULAR SIZE: 24" X 24" COLOR: WHITE EDGE: TEGULAR GRID: WHITE</p> <p>LAT5 - MAIN LOBBY SOUND ABSORBING WITH A MIX OF TILES MANUFACTURER: ARMSTRONG TYPE: OPTIMA A: 24" X 24" TEGULAR EDGE B: 6" X 24" CUT TILE SQUARE LAY IN COLOR: WHITE GRID: WHITE</p>	<p>MISCELLANEOUS</p> <p>PC - PRIVACY CURTAINS MANUFACTURER: INPRO TYPE: SHIELD BY PANAZ FULL RANGE OF FABRICS AND PATTERNS</p> <p>WP - WALL PROTECTION PANELS MANUFACTURER: INPRO STANDARD COLORS LOCATED IN ALL EVS AREAS UP TO 4'</p> <p>CG - CORNER GUARDS MANUFACTURER: INPRO STANDARD COLORS</p> <p>TP - TOILET PARTITIONS MANUFACTURER: SCRANTON PRODUCTS TYPE: STAINLESS HAMMERED</p> <p>FROSTED FILM MANUFACTURER: 3M PRODUCT: FASARA PATTERN: FULL RANGE OF PATTERNS SEE DOOR AND STOREFRONT INFORMATION FOR LOCATIONS</p>
			<p>STAIRS</p> <p>GENERAL STAIRS</p> <p>LVT2-A FLOORING</p> <p>JOHNSONITE / TARKETT ANGLE FIT RUBBER STAIR TREADS SYSTEM IN COLOR MOON ROCK</p> <p>P1 WALLS WITH P5 ACCENT</p> <p>RB2 BASE</p> <p>LOBBY MONUMENTAL STAIR</p> <p>TERRAZZO RISERS MANUFACTURER: CONCORD TERRAZZO COMPANY COLOR: TO BE SELECTED FROM FULL RANGE OF COLORS SEE SPECS FOR FURTHER INFORMATION</p> <p>PORCELAIN TILE PLANTER (WT1) BELOW STAIRS</p> <p>WOOD WALLCOVERING (WC1) ON THE GYP UNDERSIDE OF STAIRS</p>

# GENERAL FINISH NOTES

- CONTRACTOR TO PAINT 4'X4' TEST PATCH OF ALL PAINT COLORS FOR REVIEW AND APPROVAL BY DEAN ARCHITECTURE BEFORE FULL INSTALLATION
- SUBMITTALS OF ALL FINISHES/FIXTURES MUST BE PROVIDED TO DEAN ARCHITECTURE FOR APPROVAL
- ALL DOOR FRAMES TO BE CAULKED AT FLOOR. CAULK TO MATCH DOOR FRAME PAINT COLOR UNLESS OTHERWISE NOTED
- PROVIDE SCHLUTER THRESHOLD FOR ALL LVT OR CARPET TRANSITIONS TO TILE
- PROVIDE SCHLUTER JOLLY IN BRUSHED ALUMINUM FOR WALL TILE TERMINATIONS
- ALL TRIM PAINTED IN A SEMI GLOSS FINISH

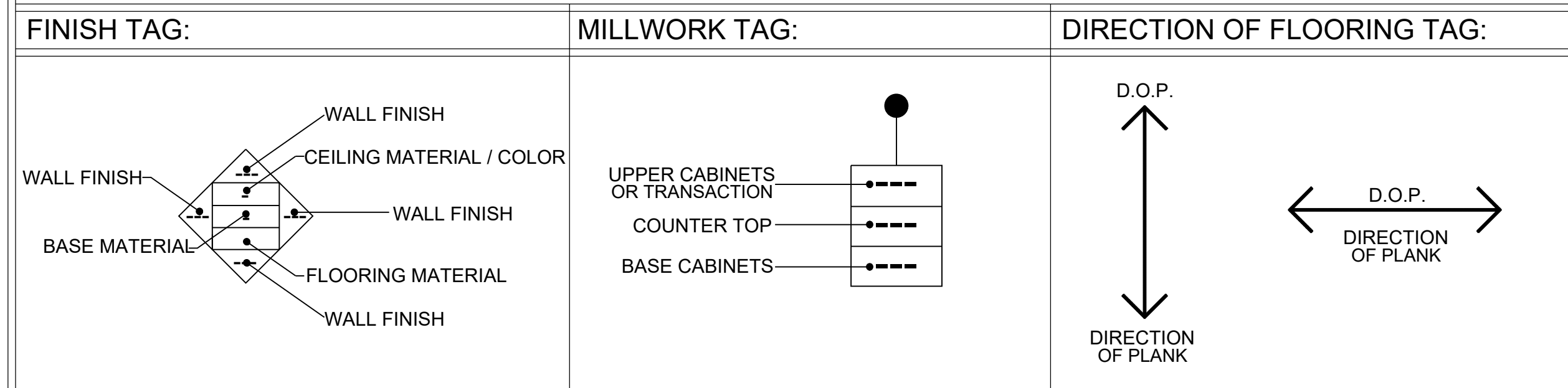

# ROOM TYPICALS

- |  |   |
|--|---|
| <p>① STORAGE / CLOSETS / MISCELLANEOUS</p> <ul style="list-style-type: none"> <li>ALL WALLS TO BE PAINTED P1</li> <li>FLOORS TO BE LVT3 - A</li> <li>CEILING TO BE LAT1 UNLESS OTHERWISE NOTED ON CEILING PLAN</li> <li>RUBBER BASE TO BE RB2</li> <li>NOTED AS ①</li> </ul>                   | <p>② TYPICAL OFFICES / MISC. ROOMS</p> <ul style="list-style-type: none"> <li>ALL WALLS TO BE PAINTED P1, UNLESS NOTED ACCENT WALL</li> <li>FLOORS TO BE LVT3</li> <li>RUBBER BASE TO BE RB2</li> <li>CEILING TO BE LAT2</li> <li>NOTED AS ②</li> </ul> |
| <p>③ STAFF / SINGLE USER RESTROOMS</p> <ul style="list-style-type: none"> <li>WET WALL TO BE WT3</li> <li>ALL OTHER WALLS TO BE P5</li> <li>CEILING TO BE LAT1 UNLESS OTHERWISE NOTED ON CEILING PLAN</li> <li>FLOORS TO BE PFT1</li> <li>RUBBER BASE TO BE RB2</li> <li>NOTED AS ③</li> </ul> | <p>④ MEP AREAS</p> <ul style="list-style-type: none"> <li>ALL WALLS TO BE P1</li> <li>REFER TO CEILING PLAN FOR CEILING FINISH</li> <li>FLOORS TO BE SEALED CONCRETE</li> <li>BASE TO BE RB2</li> <li>NOTED AS ④</li> </ul>                             |
| <p>⑤ RESTROOM</p> <ul style="list-style-type: none"> <li>WET WALL TO BE WT2</li> <li>OTHER WALLS TO BE WT6 UNLESS OTHERWISE NOTED</li> <li>CEILING TO BE LAT1 UNLESS OTHERWISE NOTED ON CEILING PLAN</li> <li>FLOORS TO BE PFT1</li> <li>BASE TO BE PBT1</li> <li>NOTED AS ⑤</li> </ul>        |   |

# KEY NOTES

- Ⓐ LEVEL 5 FINISH REQUIRED

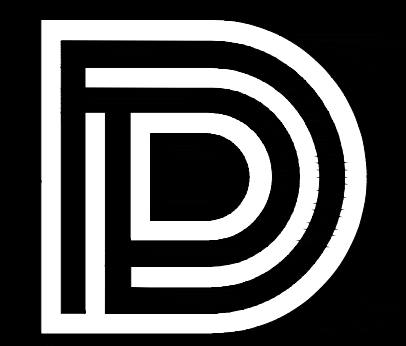

**DEAN**  
ARCHITECTURE  
GEDDIE | GRANT | OUBRE

461 Sunnybrook, Ste 140  
Ridgeland, MS 39157  
601.939.7717  
deandean.com



5/13/2024  
CONSTRUCTION DOCUMENTS

Project No. : 21041  
Date: APRIL 11, 2024  
Drawn: FBH, JMD, NAM, RMB  
Checked: KAO  
Revisions: MAY 13, 2024 - ADDENDUM #3

HEALTH SCIENCES COMPLEX -  
(RANKIN CAMPUS) HINDS COMMUNITY COLLEGE  
(COMMUNITY COLLEGE BOARD)  
PEARL, MISSISSIPPI

Sheet Number:

**A900**

FINISH LEGEND & NOTES

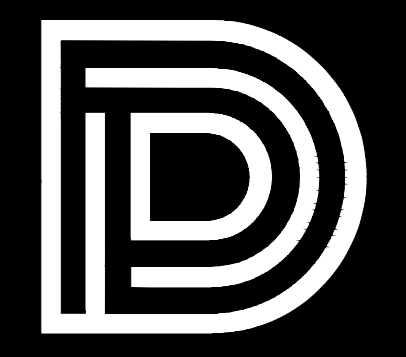

**DEAN**  
ARCHITECTURE  
GEDDIE | GRANT | OUBRE

461 Sunnybrook, Ste 140  
Ridgeland, MS 39157  
601.939.7717  
deandean.com

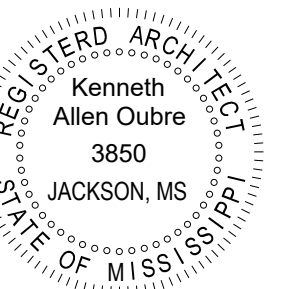

5/13/2024  
CONSTRUCTION  
DOCUMENTS

Project No. : 21041  
Date: APRIL 11, 2024  
Drawn: FBH, JMD, NAM, RMB  
Checked: KAO  
Revisions: MAY 13, 2024 - ADDENDUM #3

HEALTH SCIENCES COMPLEX -  
(RANKIN CAMPUS) HINDS COMMUNITY COLLEGE  
(COMMUNITY COLLEGE BOARD)  
PEARL, MISSISSIPPI

Sheet Number:

**A901A**

FIRST FLOOR FINISH  
PLAN  
PART "A"

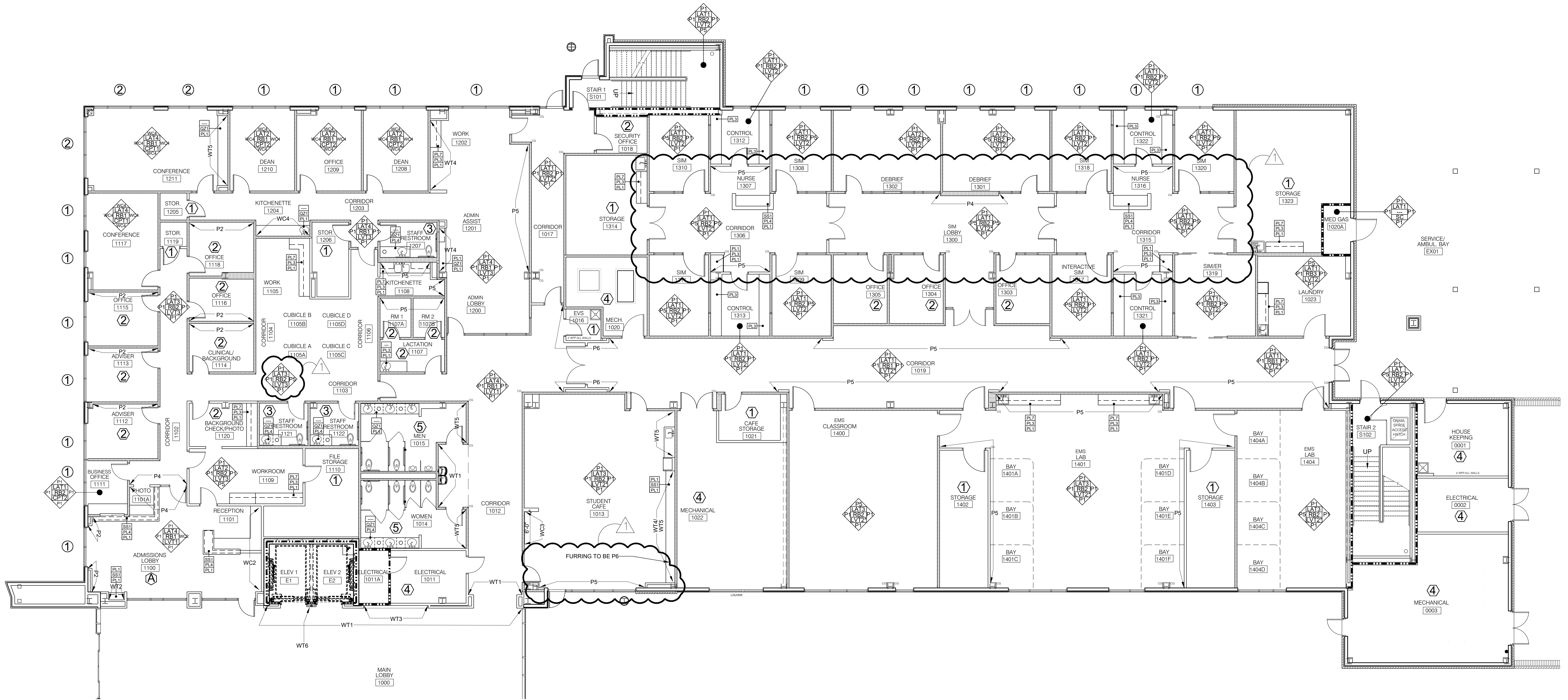

**1** FIRST FLOOR PLAN - PART "A"  
A901A SCALE: 1/8"=1'-0"

WINDOW TREATMENT	
①	MANUAL ROLLER SHADE
②	MANUAL ROLLER SHADE WITH BLACK OUT SHADE
③	ELECTRONIC ROLLER SHADE (GC TO PROVIDE & COORDINATE POWER REQUIREMENTS. LOCATE SWITCH IN FIELD W/ ARCHITECT)

NOTE: WHERE WINDOW WIDTH REQUIRES MORE THAN ONE WINDOW SHADE THE SEAM SHALL BE CENTERED ON A VERTICAL MULLION

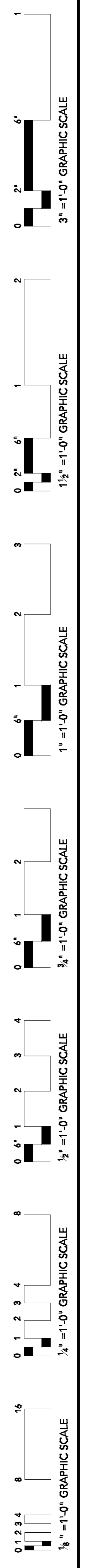

MAY 13, 2024

HEALTH SCIENCES COMPLEX (RANKIN CAMPUS)  
HINDS COMMUNITY COLLEGE (COMMUNITY COLLEGE BOARD)  
PEARL, MISSISSIPPI

STRUCTURAL ADDENDUM #3

RFI RESPONSE

Item No. 1 Comment: "We'd like to suggest a unit price for auger pile casings."

Response: Auger Cast piles are not drilled, straight shaft piling. Casings will not be necessary due to the method of construction.

ADDENDUM

Item No. 1 Ref. Sheet S203 – Elevator Pile Cap – All piles on this detail shall be 18" Dia. Auger Cast Piles.

Item No. 2 Ref. Sheet S203 – Auger Cast Pile Elevation – Vertical reinforcing shall be (6) #8's w/ hook. Omit the "17'-0"" dimension.

Item No. 3 Ref. Sheet S204 – Detail 2/S204 – The area way penetration through the wall shall be 24"X24".

Item No. 4 Ref. Sheet S100 – "Concrete" – Omit "Piles ----- 3000 PSI". Pile concrete shall be 4000 psi per specifications.



May 13, 2024

**ADDENDUM NO. THREE (3) – CIVIL ENGINEERING ITEMS**

Health Sciences Complex  
(Rankin Campus) Hinds Community College  
(Community College Board)  
Pearl, Mississippi

The following changes and clarifications are hereby made a part of and take precedence over conflicting sections of the Drawings and Specifications.

**CIVIL - GENERAL INFORMATION AND CLARIFICATIONS:**

- 1.1 Item #1 – Inlet grates in the plaza area shall be stainless steel with punched holes to match the trench drain grate at the south entrance plaza.

**CIVIL – PERTAINING TO THE SPECIFICATIONS:**

- 1.2 None.

**CIVIL – PERTAINING TO THE DRAWINGS:**

- 1.3 Item #1 – Revised Sheet C2.2 Grading and Drainage. See attached.
- 1.4 Item #2 – Revised Sheet C5.1 Miscellaneous Detail. See attached.

**END OF CIVL ITEMS FOR ADDENDUM NO. THREE (3)**

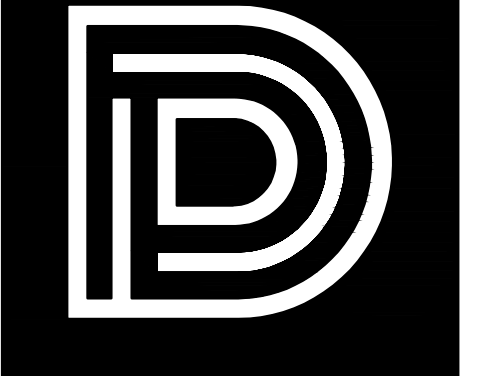

**DEAN**  
ARCHITECTURE  
GEDDIE | GRANT | OUBRE

661 Sunnybrook, Ste 140  
Ridgeland, MS 39157  
601.939.7717  
deandean.com

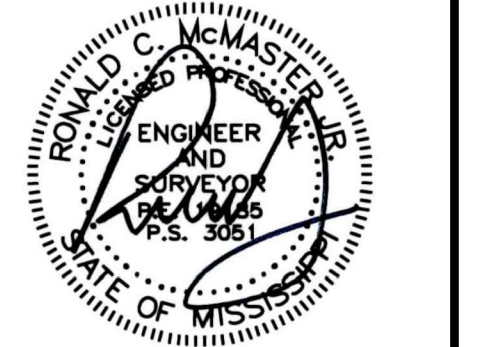

CONSTRUCTION  
DOCUMENTS

Project No. 21041  
Date: APRIL 11, 2024  
Drawn: DP  
Checked: RCM  
Revisions: Addendum No. 3 May 13, 2024

HEALTH SCIENCES COMPLEX —  
(RANKIN CAMPUS) HINDS COMMUNITY  
COLLEGE (COMMUNITY COLLEGE BOARD)  
PEARL, MISSISSIPPI

Sheet Number:

C2.2

GRADING AND  
DRAINAGE

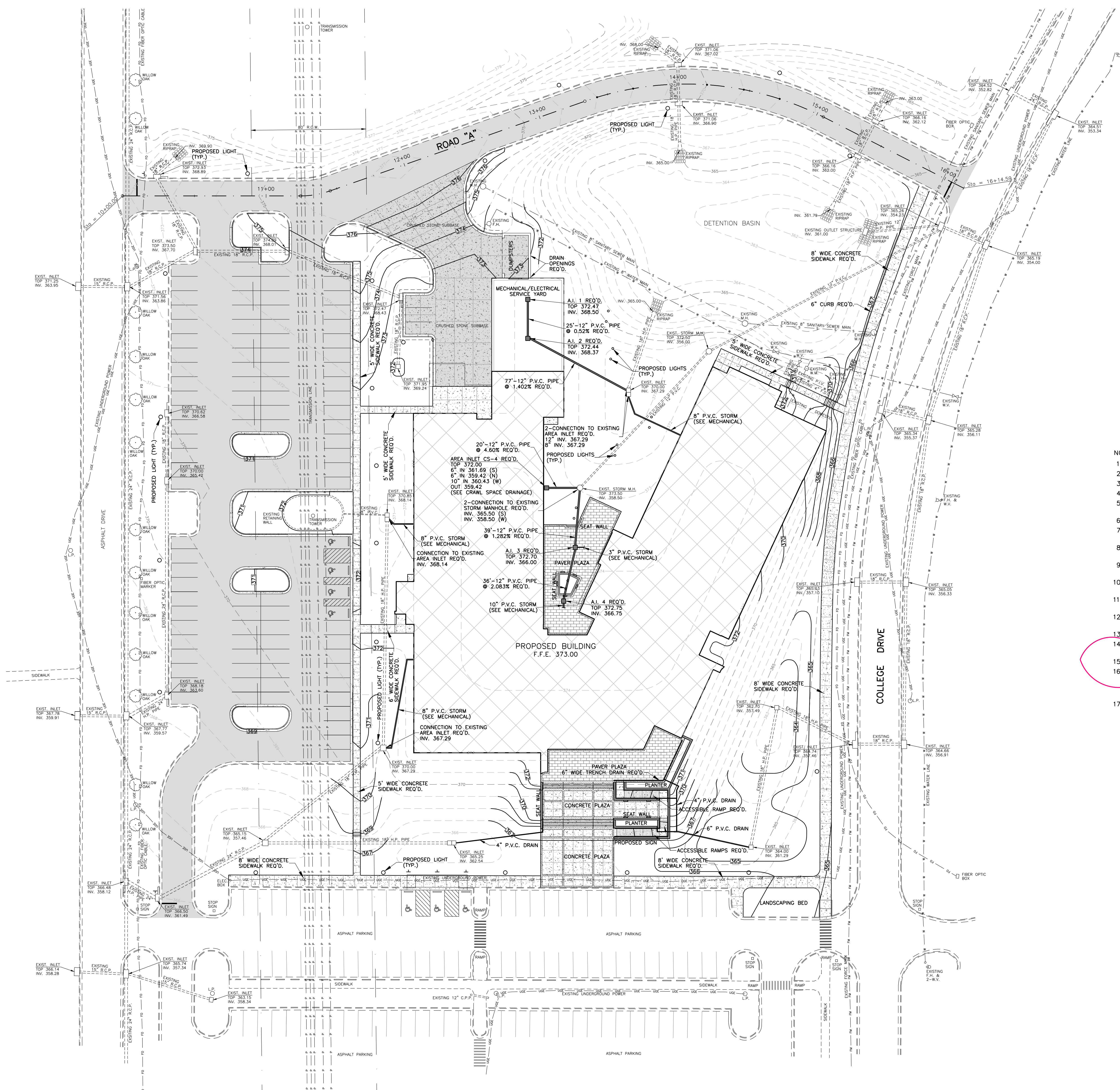
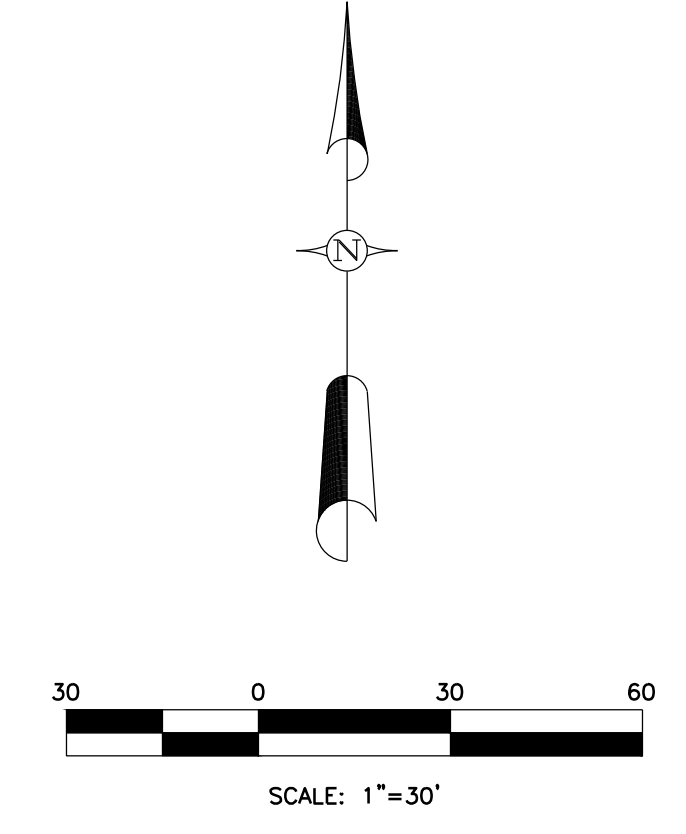

- NOTES:
1. CONTOUR INTERVAL = 1.00 FEET.
  2. THE INVERTS OF ALL INLETS SHALL BE GROUTED TO INSURE POSITIVE DRAINAGE.
  3. THE TOPS OF ALL INLETS SHALL MATCH THE SLOPE AND GRADE OF FINISHED ELEVATIONS.
  4. REFER TO GEOTECHNICAL REPORT FOR EXISTING SOILS INFORMATION AND GRADING/UNDERCUT REQ'S.
  5. BEFORE BACKFILLING AND SUBGRADE OPERATIONS COMMENCE, 98% DENSITY AND ACCEPTABLE STABILITY IS REQUIRED.
  6. CONTRACTOR TO ADJUST AREA INLET TOP ELEVATIONS TO FINISHED GRADE.
  7. ALL REFERENCES TO A.I. REFERS TO AREA INLETS, C.I. REFERS TO CURB INLETS, AND J.B. REFERS TO JUNCTION BOX.
  8. ALL ROOF DRAIN PIPE SHALL BE P.V.C., SCHEDULE 40. A CLEANOUT WILL BE REQUIRED AT ALL BENS IN ROOF DRAIN FOR ACCESS AND MAINTENANCE.
  9. CONNECT ALL ROOF DRAINS TO INTERNAL ROOF LEADER FROM BUILDING. (CLEANOUT WITH LOCKABLE LID REQUIRED—TYPE TO BE APPROVED) (SEE MECHANICAL FOR LOCATIONS).
  10. CONTRACTOR SHALL NOTIFY ENGINEER IF ANY UNKNOWN STORM PIPING IS DISCOVERED DURING PROJECT.
  11. CONTRACTOR SHALL COORDINATE THE REMOVAL OF EXISTING STORM AND SANITARY SEWERS WITH THE INSTALLATION OF THE NEW UTILITIES.
  12. AREA INLETS LOCATED WITHIN SIDEWALKS, WALKWAYS, AND PLAZAS, SHALL HAVE ADA COMPLIANT AND HEEL-PROOF RATED RUST-PROOF GRATES. TYPE TO BE APPROVED BY THE ARCHITECT.
  13. SEE LANDSCAPING AND ELECTRICAL FOR SLEEVING AND CONDUIT LOCATIONS.
  14. CONTRACTOR TO MODIFY THE LOCATION OF PROP. LIGHT POLE BASES TO PREVENT INTERFERENCE WITH PROP. STORM SEWER AND INLETS.
  15. INLET GRATES IN PLAZA AREA SHALL BE STAINLESS STEEL.
  16. SHOULD UNSTABLE SOILS BE ENCOUNTERED IN PIPE TRENCH BOTTOMS, CONTRACTOR SHALL OVEREXCAVATE A MINIMUM OF 18" AND BACKFILL WITH SELECT STRUCTURAL FILL. IF ENCOUNTERED, ADDITIONAL UNDERCUT AREAS MUST BE INSPECTED BY THE ENGINEER PRIOR TO BACKFILL OPERATIONS COMMENCING.
  17. ALL AREAS SHALL BE GRADED TO DRAIN.

**LEGEND**

	EXISTING CONTOUR
	PROPOSED CONTOUR
	EXISTING WATER LINE
	EXISTING OVERHEAD POWERLINE
	EXISTING SANITARY SEWER LINE
	EXISTING SANITARY SEWER FORCE MAIN
	EXISTING FIBER OPTIC CABLE
	EXISTING UNDERGROUND ELECTRIC CABLE
	PROPOSED PARKING/DRIVE LANES/ENTRANCE/EXITS
	PROPOSED HEAVY-DUTY CONCRETE PAVEMENT
	PROPOSED CONCRETE AREAS
	PROPOSED BUILDING

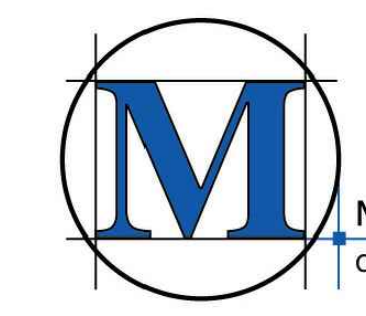

**McMASTER & ASSOCIATES, INC.**  
CIVIL ENGINEERS & LAND SURVEYORS

212 WATERFORD SQUARE  
SUITE 300  
MADISON, MS 39110  
601.605.1090

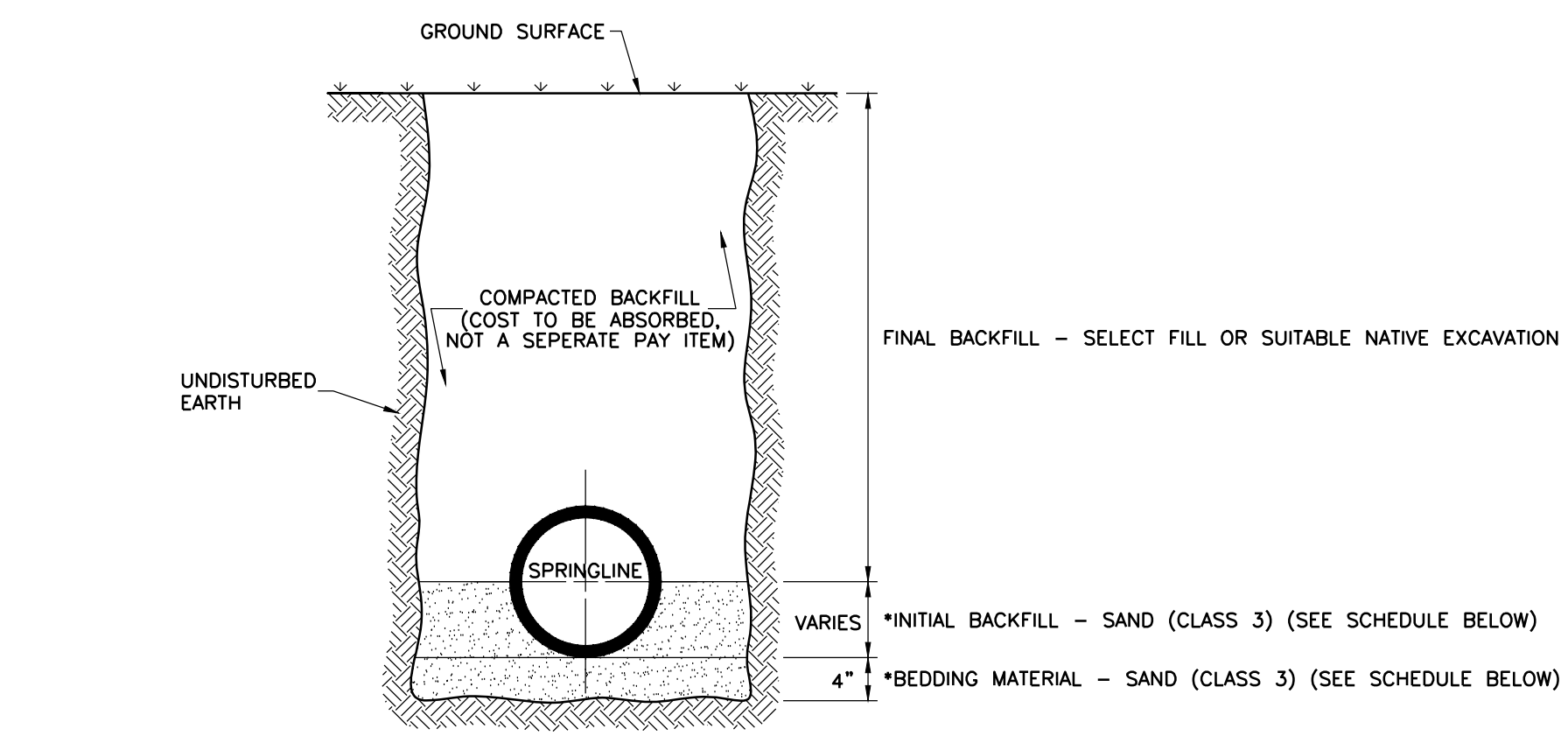

TYPICAL TRENCH CROSS-SECTION FOR HIGH-PERFORMANCE POLYPROPYLENE PIPE (H.P. PIPE) AND P.V.C. PIPE

CLASS	3
PERCENT PASSING NO. 200 SIEVE (MAX.)	10
FRACTION PASSING NO. 40 SIEVE LIQUID LIMIT (MAX.)	--
PLASTICITY INDEX (MAX.)	np

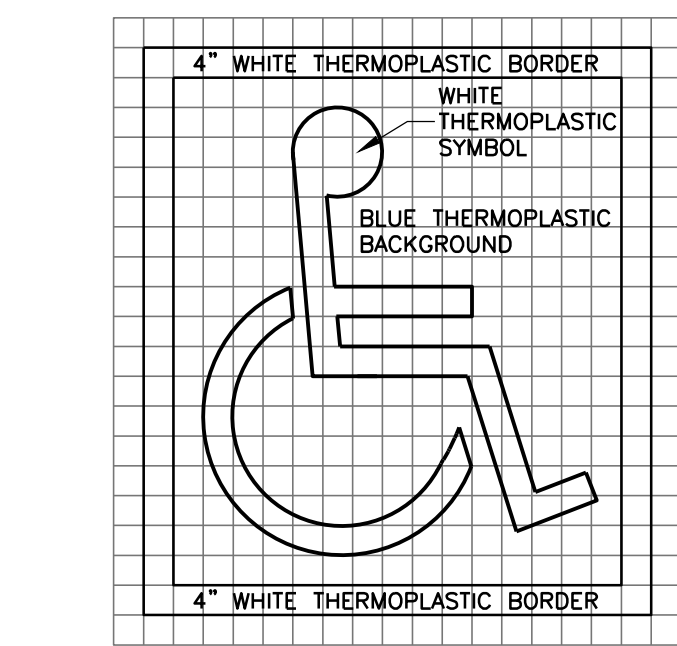

TYPICAL THERMOPLASTIC ACCESSIBLE SYMBOL FOR PAVEMENT

N.T.S.

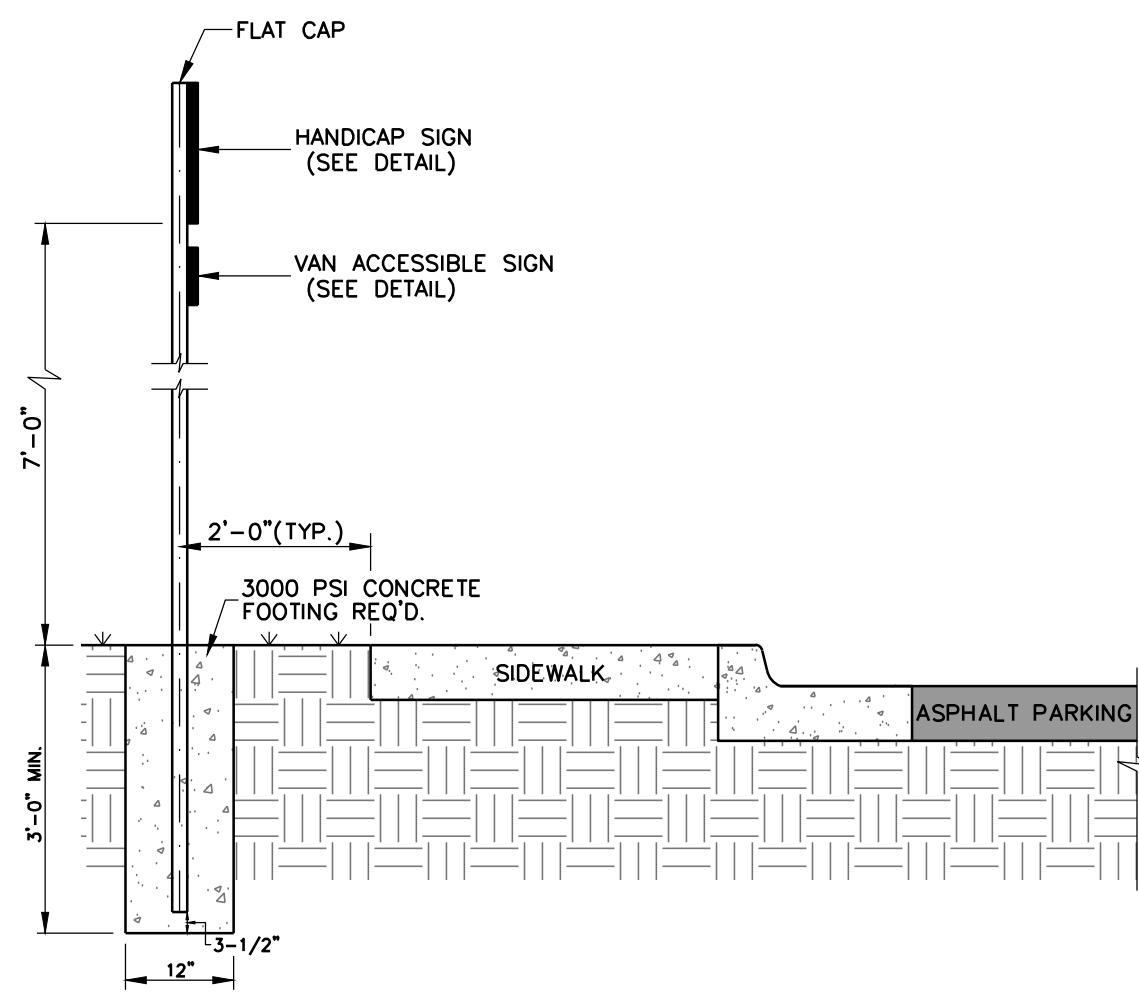

FOOTING DETAIL FOR HANDICAP PARKING SIGN

N.T.S.

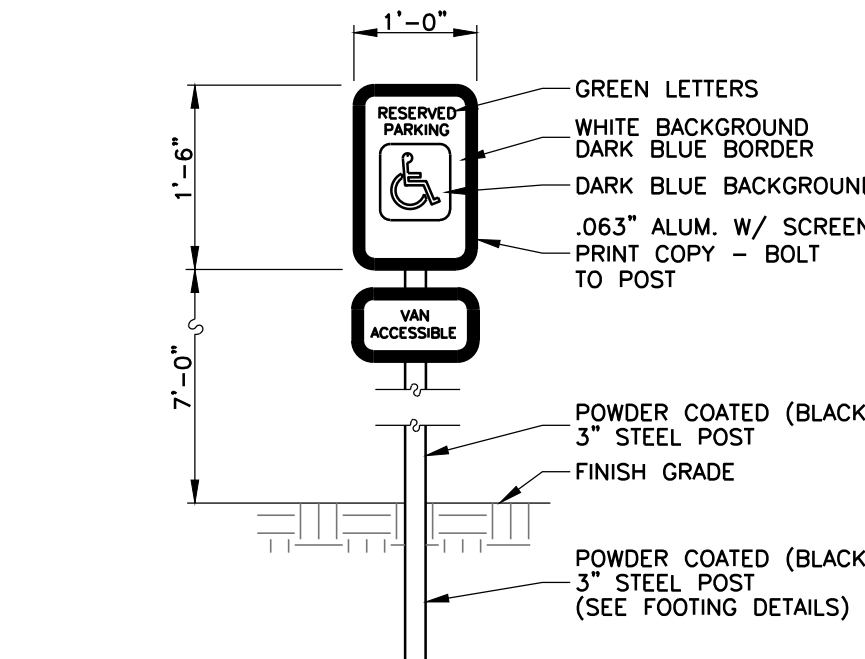

SIGN AT HANDICAP PARKING SPACE

N.T.S.

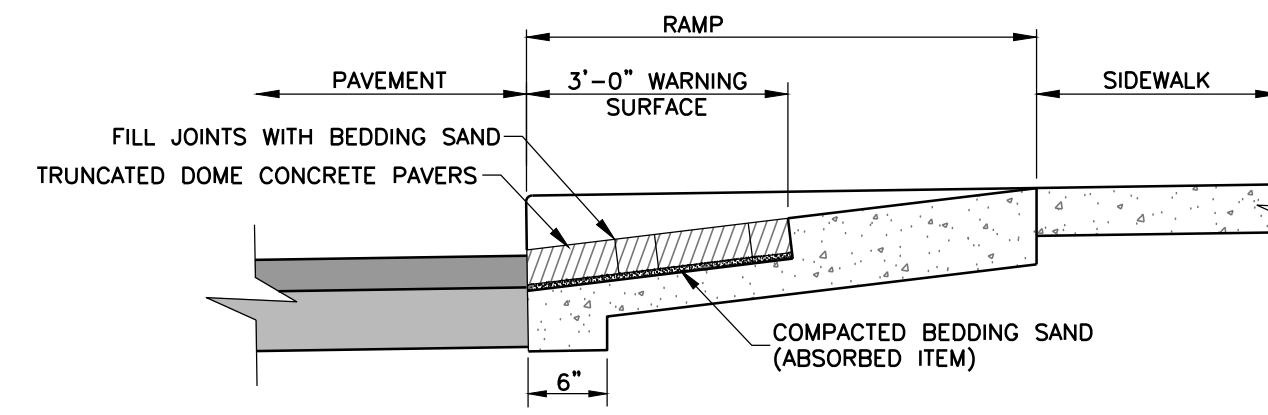

TYPICAL DETECTABLE WARNING INSTALLATION

NOTE: DETECTABLE WARNING PAVERS AT THE SIDEWALKS SHALL MATCH EXISTING DETECTABLE WARNING PAVERS ON SITE.

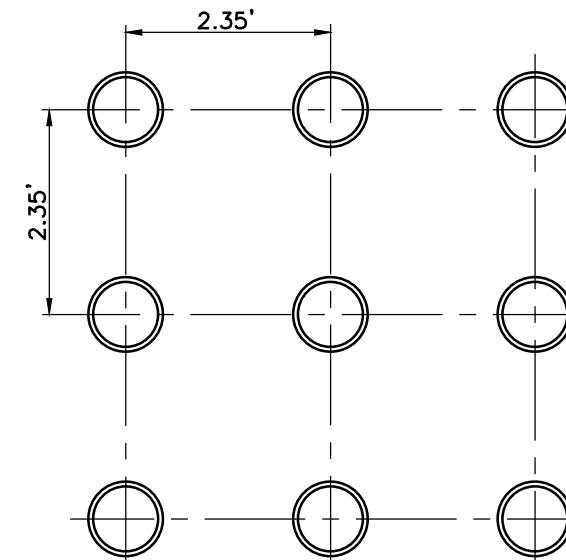

SQUARE PATTERN

N.T.S.

- NOTES:
1. LANDINGS WILL PROVIDE A LEVEL AREA (LESS THAN 2% GRADE OR CROSS SLOPE) AT APPROXIMATE STREET ELEVATION. A 4 FOOT SQUARE LEVEL LANDING IS THE REQUIRED MINIMUM.
  2. ALL SIDEWALK RAMP REQUIRE DETECTABLE WARNINGS.
  3. ANY DRIVEWAY 24" OR GREATER REQUIRES ADA SIDEWALK TREATMENTS WITH DETECTABLE WARNINGS WHICH WILL BE INCIDENTAL TO THE ENTRANCE CONSTRUCTION.
  4. DETECTABLE WARNINGS SHALL BE INCIDENTAL TO SIDEWALK CONSTRUCTION.
  5. DETECTABLE WARNING SURFACE BEGINS AT THE BACK OF CURB.

DETECTABLE WARNING DETAILS

N.T.S.

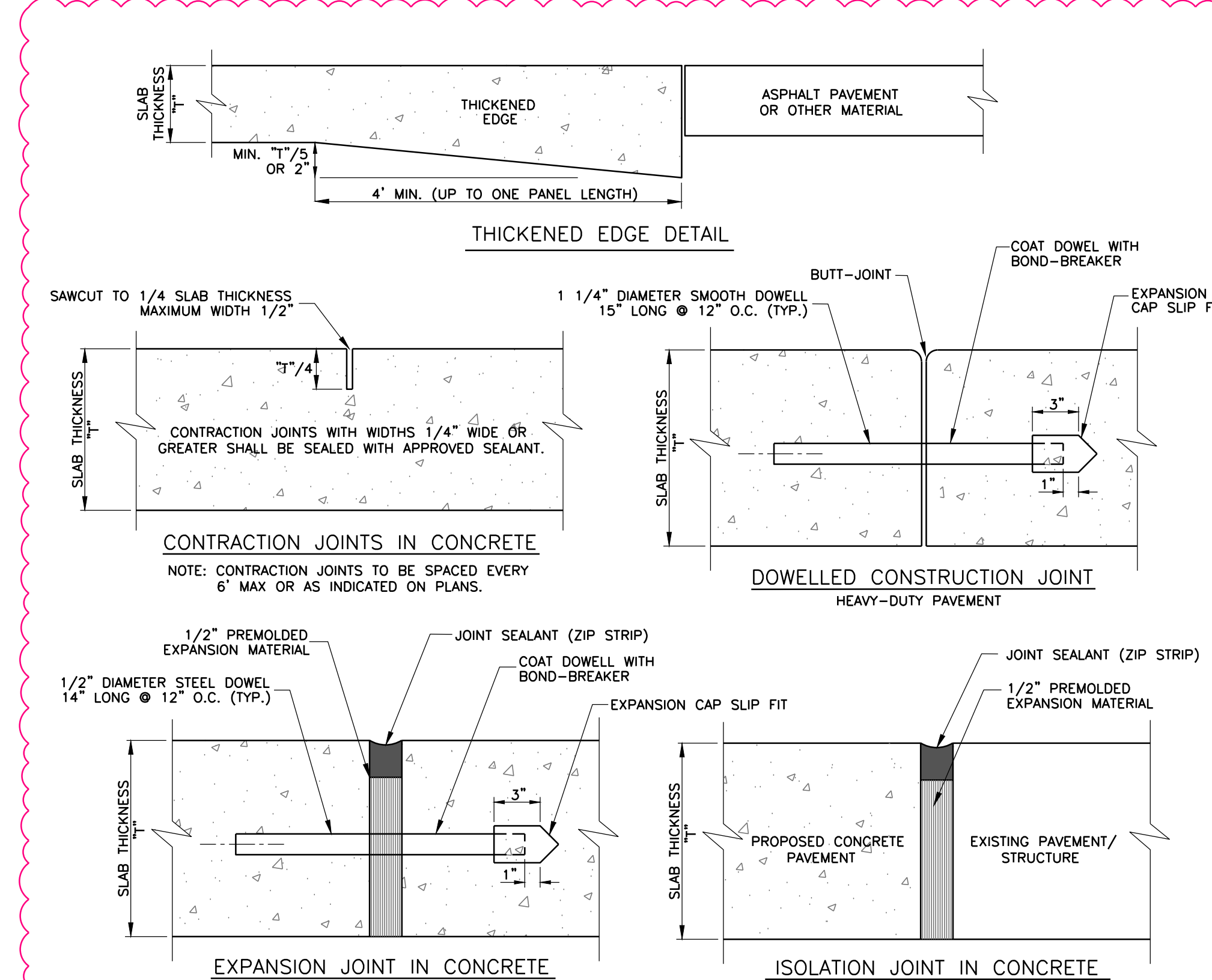

CONCRETE JOINT DETAILS

N.T.S.

- NOTES:
1. EXPANSION JOINTS TO BE SPACED EVERY 48' MAX. IN CONCRETE SIDEWALKS.
  2. PROVIDE THICKENED EDGE (1" + 1" INCH) 12" EACH SIDE OF EXPANSION FOR PAVEMENT THICKNESS "T" LESS THAN 5".

CONCRETE JOINT DETAILS

N.T.S.

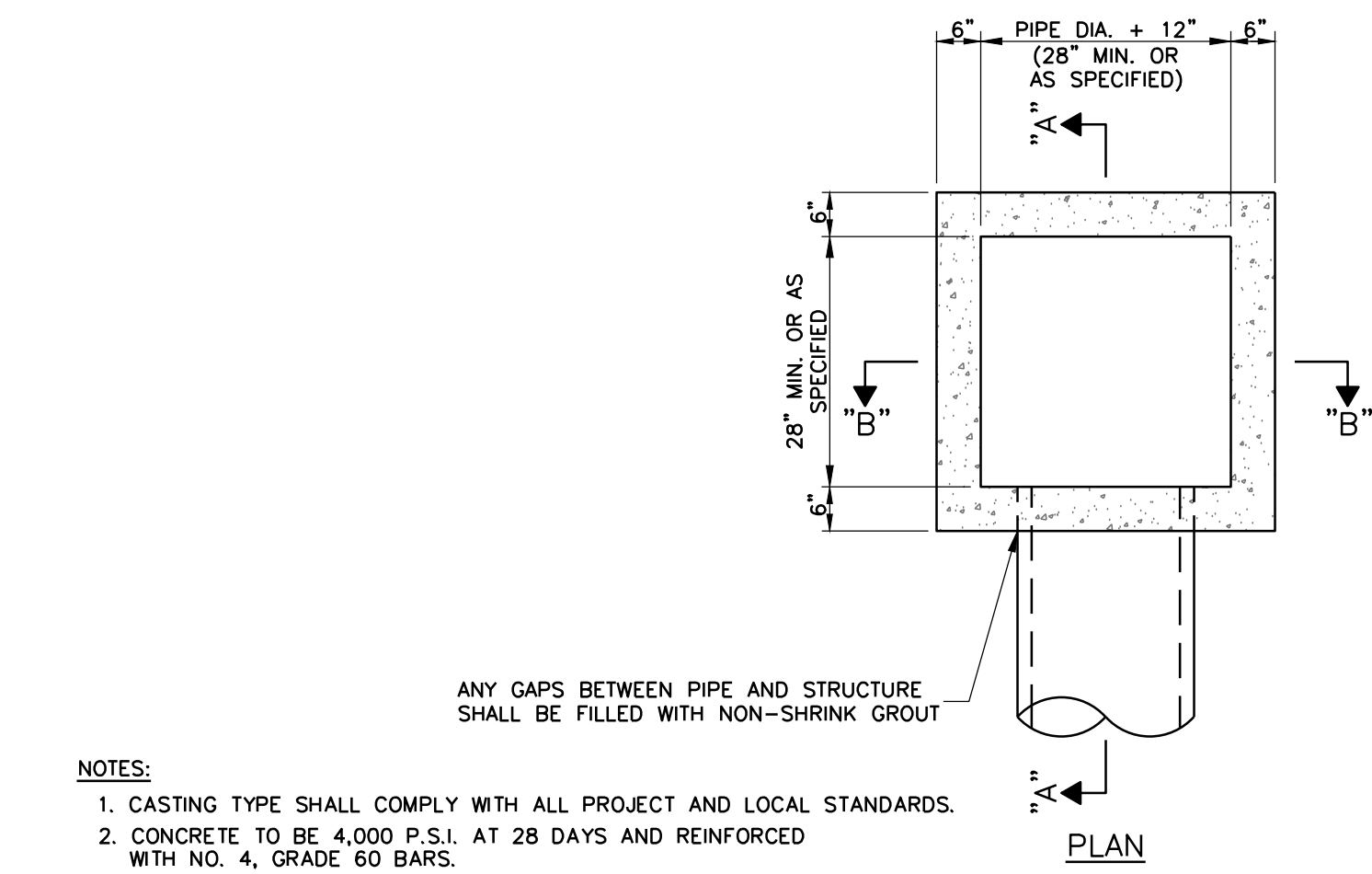

SINGLE PRECAST AREA INLET DETAILS (LOCATED IN PAVEMENT)

N.T.S.

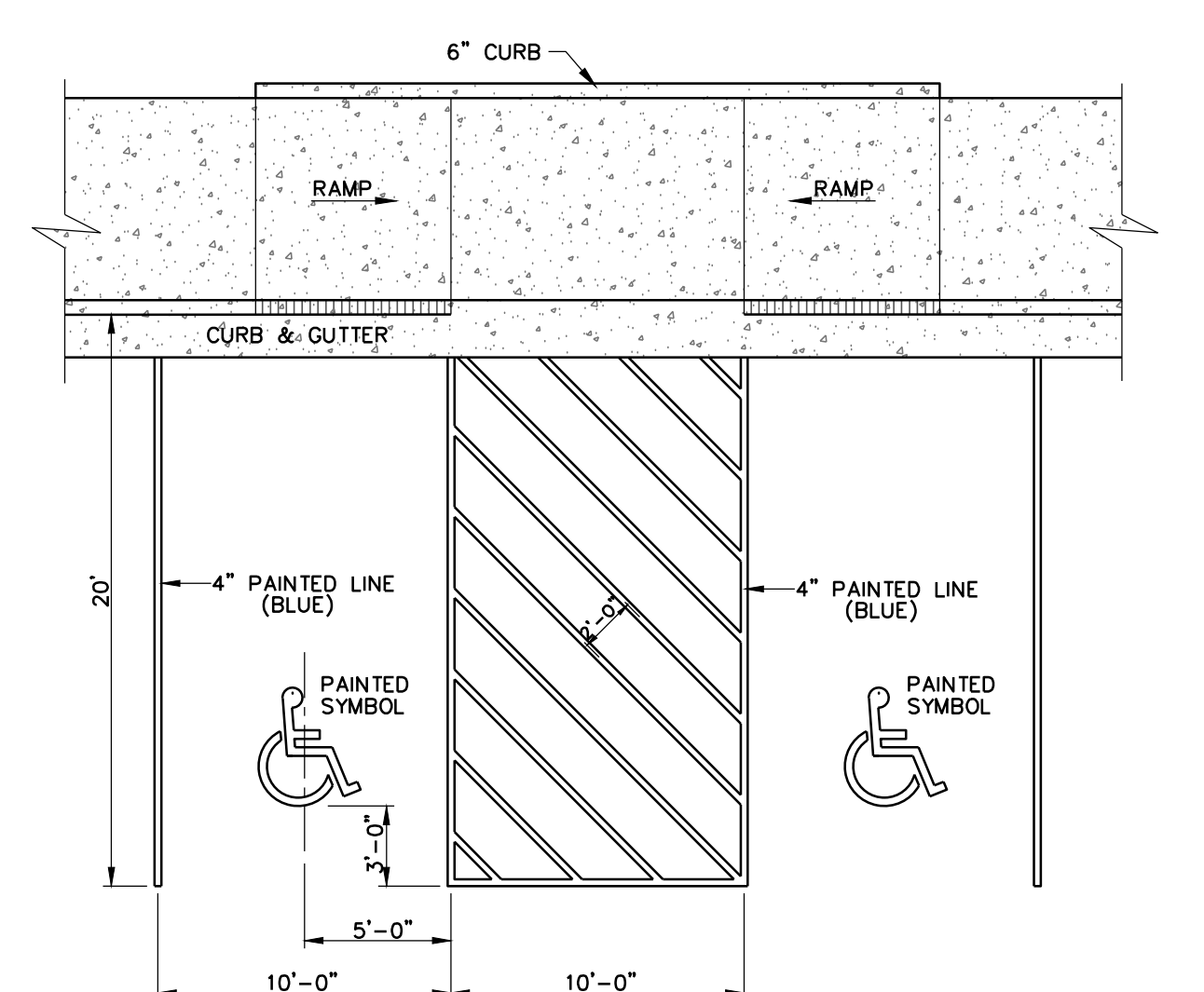

HANDICAP PARKING DETAILS

N.T.S.

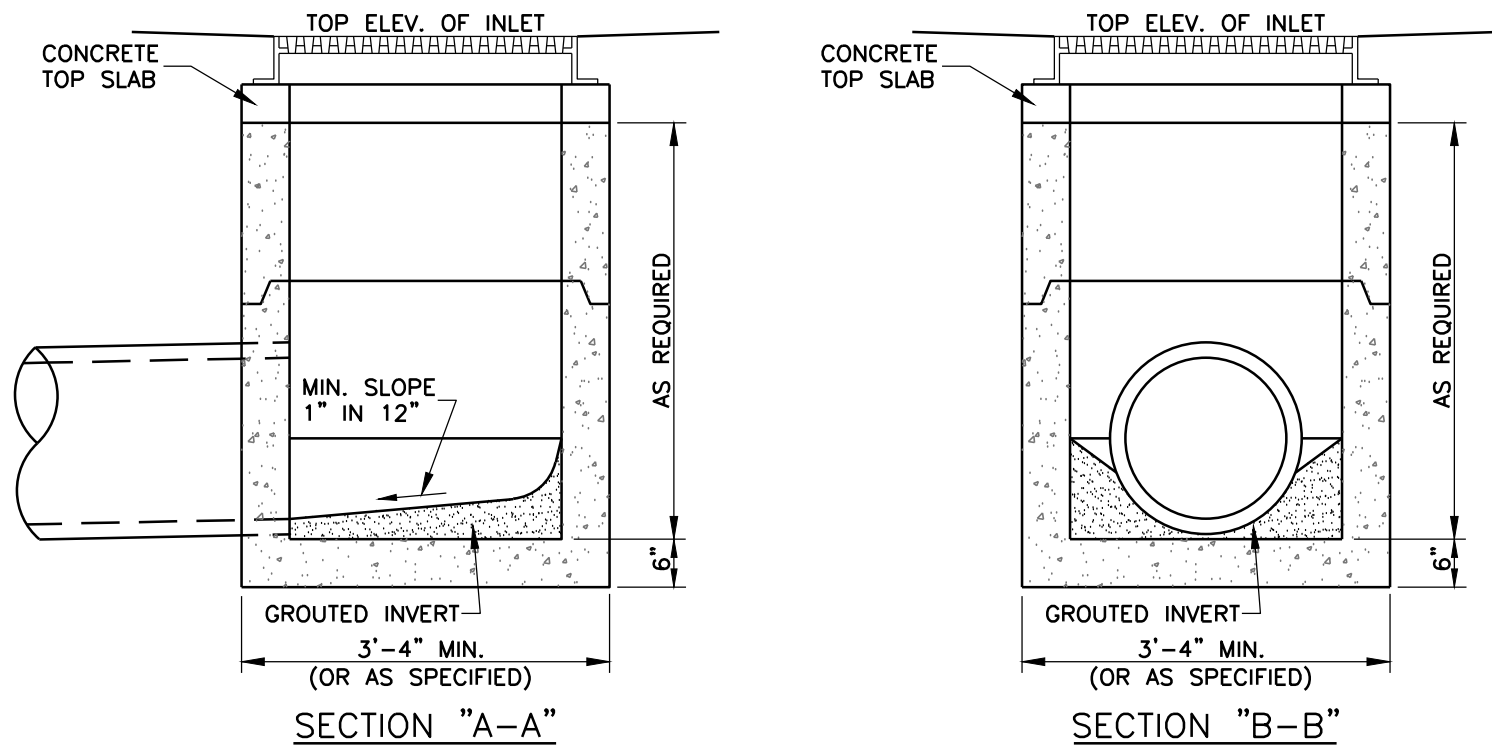

HEAVY-DUTY CONCRETE PAVEMENT SECTION

N.T.S.

- NOTES:
1. MAXIMUM JOINT SPACING SHALL BE 15'-0".
  2. REINFORCING REQUIRED FOR IRREGULAR SHAPED PANELS AND PANELS WITH ACUTE ANGLES. IRREGULAR SHAPED PANELS ARE CONSIDERED TO BE ONES IN WHICH THE SLAB TAPERS TO A SHARP ANGLE, WHEN THE LENGTH TO WIDTH RATIO EXCEEDS 1.5, OR WHEN THE SLAB IS NEITHER SQUARE OR RECTANGULAR.

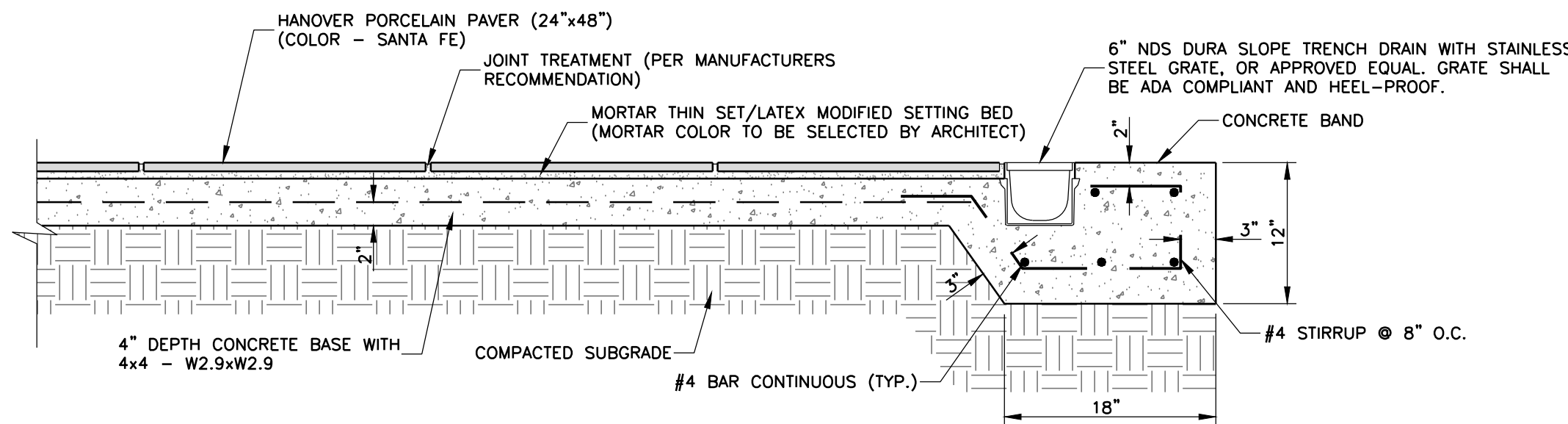

PAVER PLAZA AND TRENCH DRAIN DETAIL

N.T.S.

- TRENCH DRAIN NOTES:
1. WORK SHALL INCLUDE INSTALLATION OF DURA SLOPE IN-LINE CATCH BASIN AND 4" P.V.C. OUTLET PIPE.
  2. TRENCH DRAIN REBAR SUPPORTS (IF USED) SHALL NOT EXTEND BEYOND LIMITS OF CONCRETE. MINIMUM COVER REQUIREMENTS SHALL BE MAINTAINED.
  3. MINIMUM UPSTREAM DEPTH SHALL BE 4".

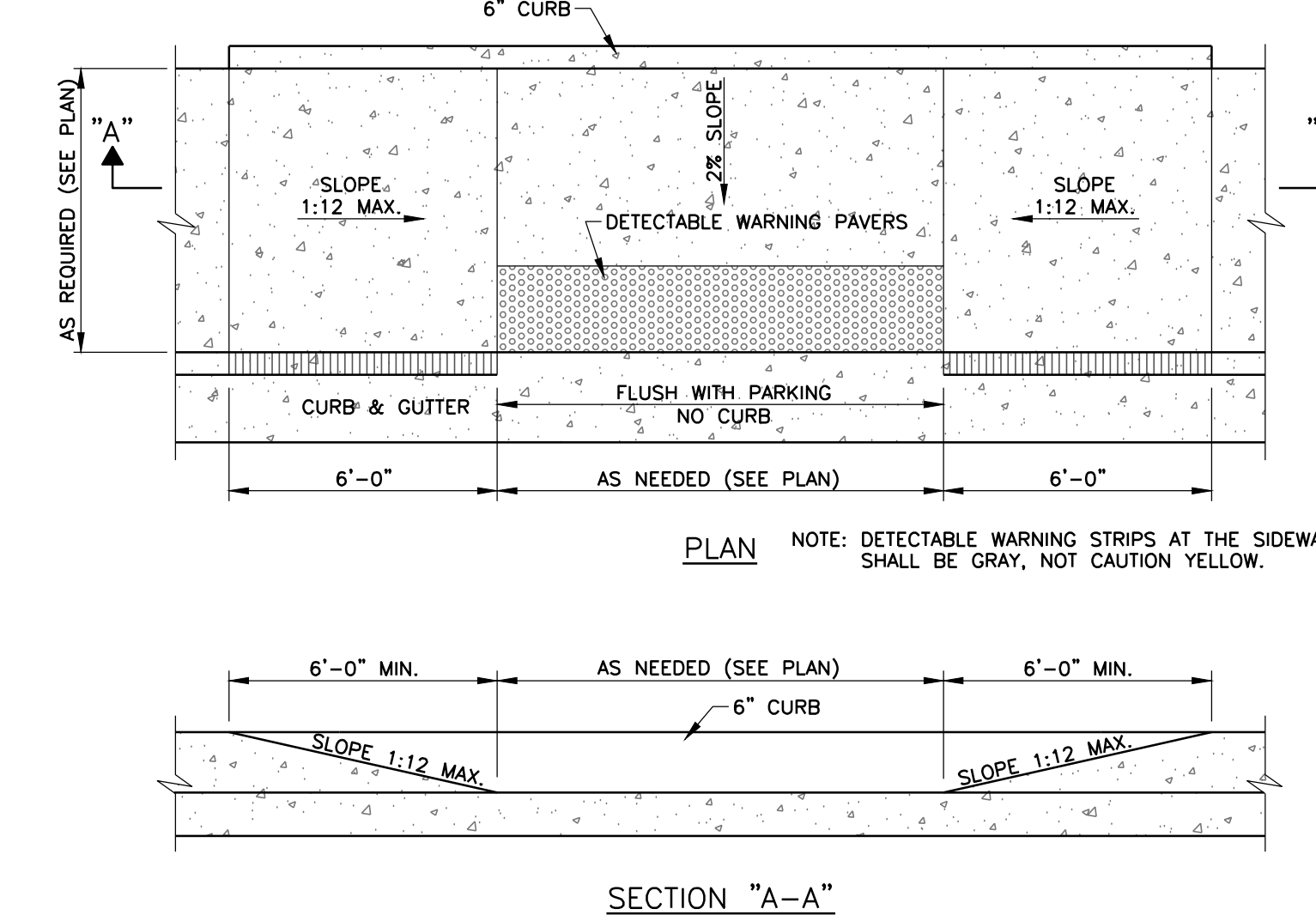

ACCESSIBLE RAMP IN SIDEWALK FOR HANDICAP PARKING

N.T.S.

NOTE: SURFACE TEXTURE OF THE RAMP SHALL BE THAT OBTAINED BY A COARSE BROOMING, TRANSVERSE TO THE SLOPE OF THE RAMP.

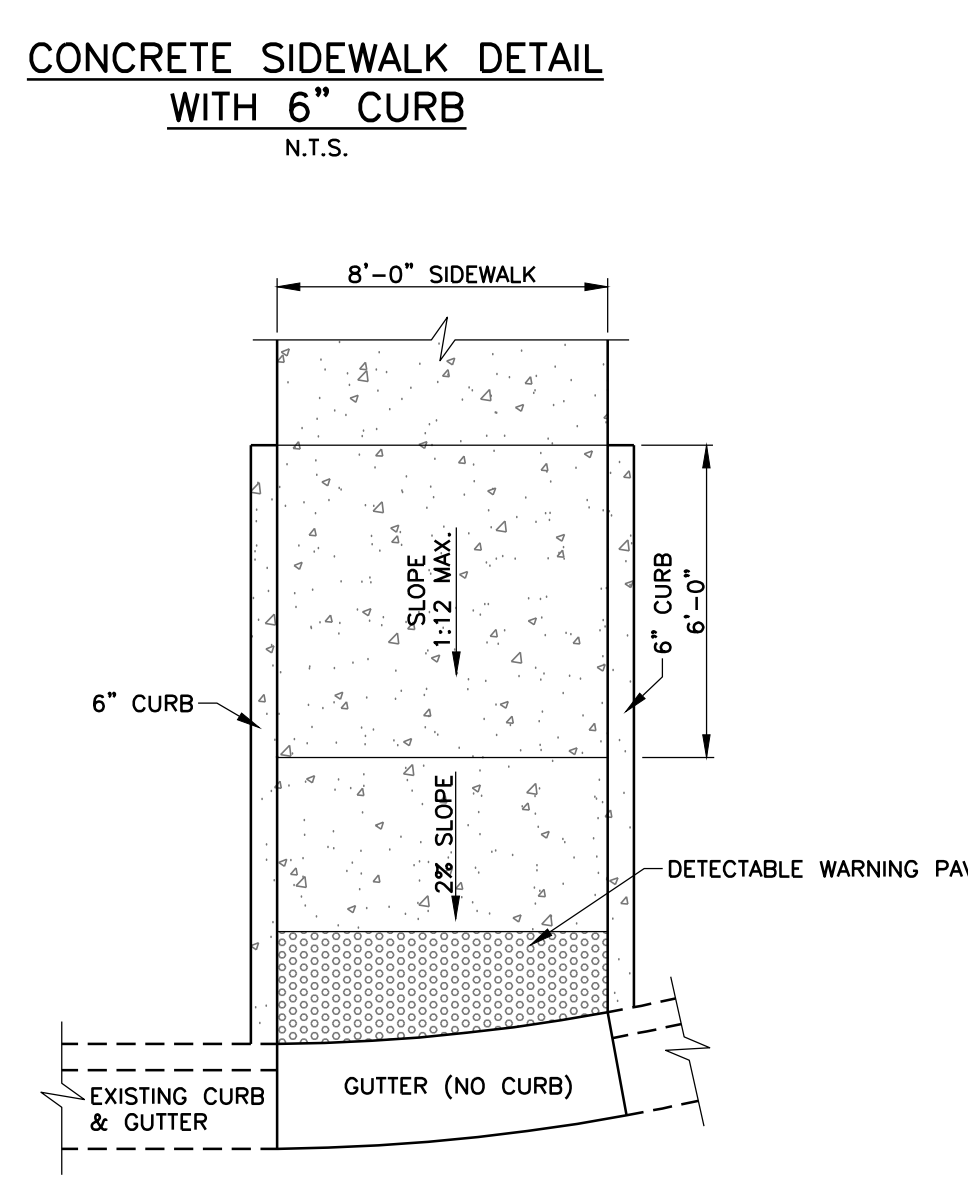

ACCESSIBLE RAMP IN SIDEWALK FOR CROSSWALK

N.T.S.

NOTE: SURFACE TEXTURE OF THE RAMP SHALL BE THAT OBTAINED BY A COARSE BROOMING, TRANSVERSE TO THE SLOPE OF THE RAMP.

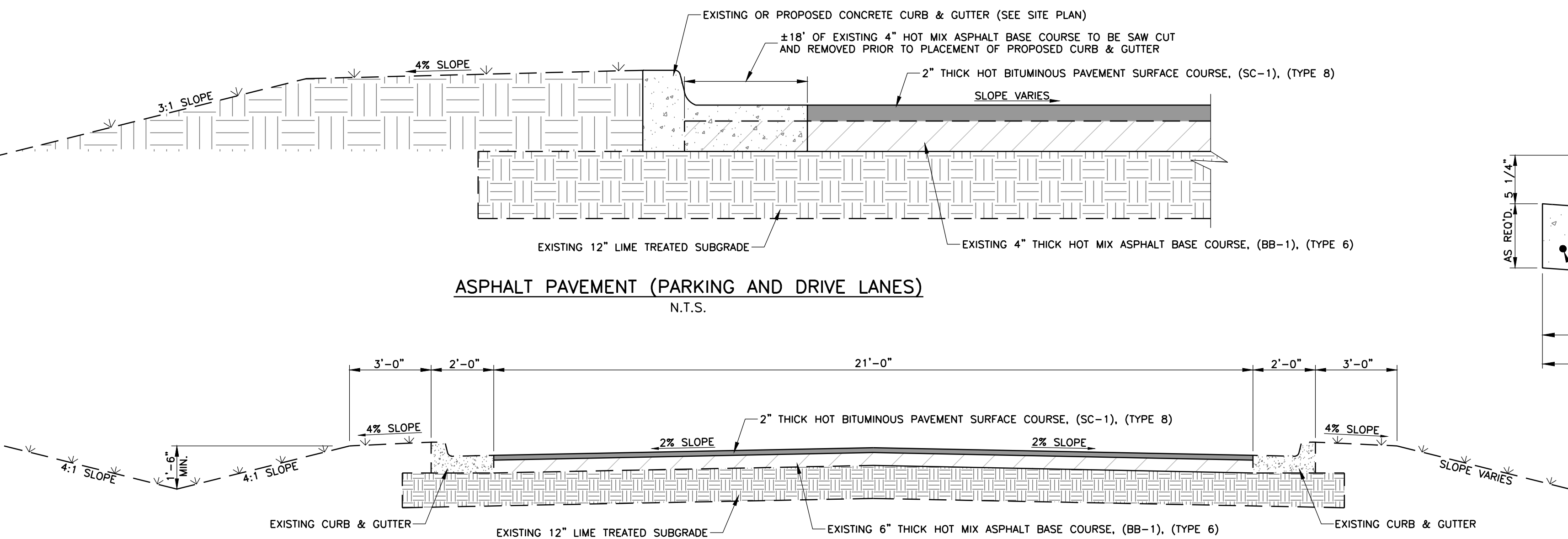

TYPICAL SECTION (ROAD "A")

N.T.S.

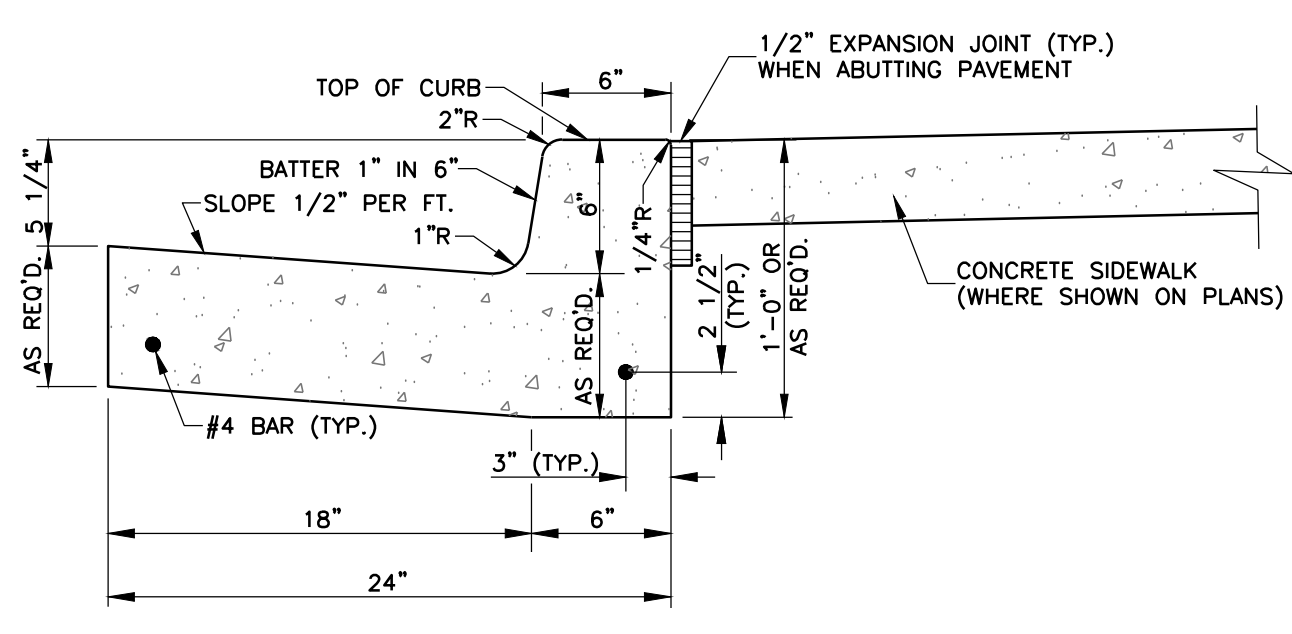

NORMAL GUTTER

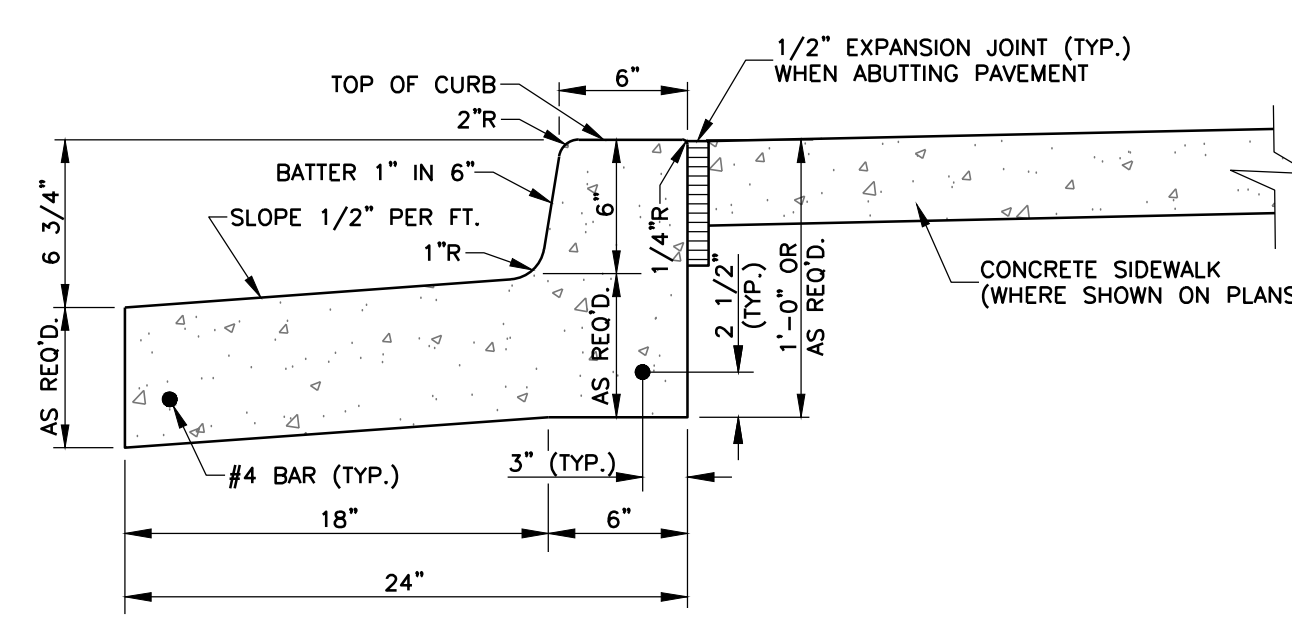

PITCHED GUTTER

CONCRETE CURB AND GUTTER DETAIL

N.T.S.

- NOTES:
1. CONCRETE SHALL BE 4,000 P.S.I. MINIMUM.
  2. PROVIDE CONTRACTION JOINTS AT 10'-0" O.C. AND EXPANSION JOINTS AT 40'-0" O.C.
  3. CONTRACTION JOINTS SHALL BE A MINIMUM OF 1" OF DEPTH AND A MAXIMUM OF 1/4 DEPTH OF THE PAVEMENT. EDGES SHALL BE TOOLED TO A 1/4" RADIUS.
  4. EXPANSION JOINTS SHALL BE 1/2" IN WIDTH AND FILLED WITH PREMOULDED EXPANSION JOINT FILLER TO WITHIN 1/2" OF THE SURFACE. EDGES SHALL BE TOOLED TO A 1/4" RADIUS AND SEALED FLUSH WITH AN APPROVED SEALANT.
  5. CONTRACTOR TO FIELD VERIFY TYPE OF GUTTER PITCH USED.

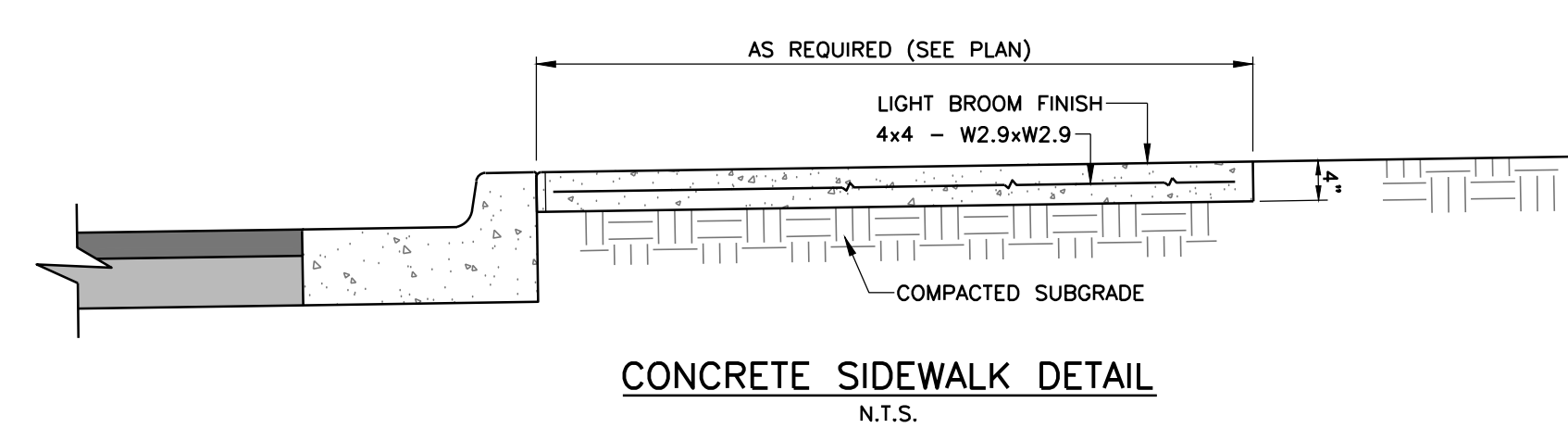

CONCRETE SIDEWALK DETAIL

N.T.S.

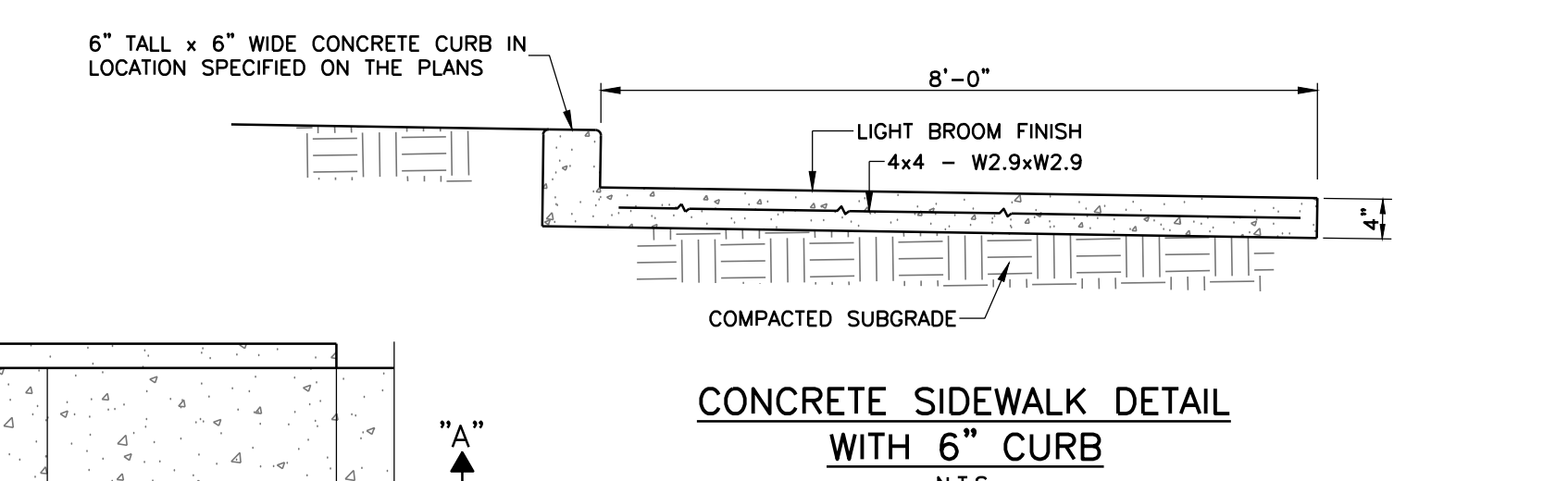

CONCRETE SIDEWALK DETAIL WITH 6" CURB

N.T.S.

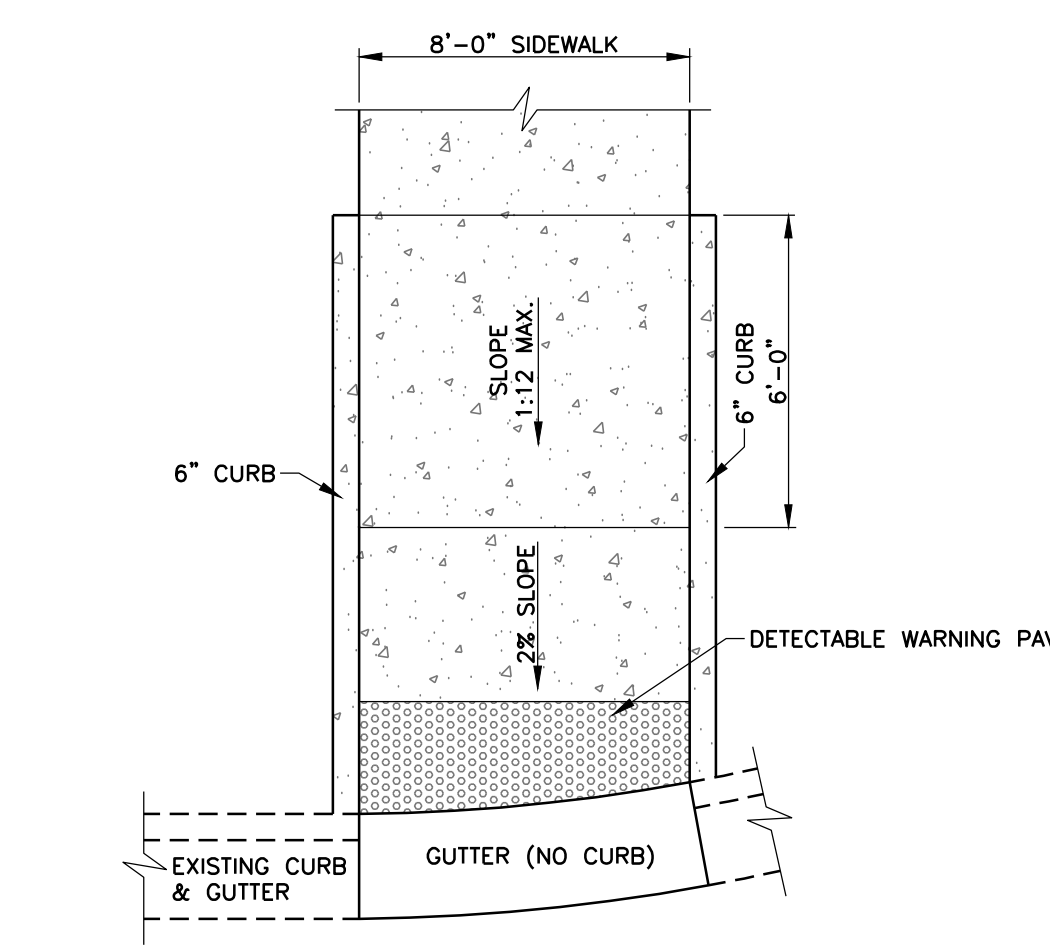

CURB END TRANSITION DETAIL

N.T.S.



**May 13, 2024**

**ADDENDUM NO. THREE (3)**

Hinds CC HSC  
ERG P.N. 23.024

I. CLARIFICATIONS TO DRAWINGS AND SPECIFICATIONS

- A. All headwalls to be provided by owner and installed by plumbing contractor.

II. PERTAINING TO THE DRAWINGS

- A. M100 – Replace this sheet in its entirety
  - a. Added C-1 and C-2 louvers.
- B. M601 – Replace this sheet in its entirety
  - a. Added C-1 and C-2 louvers.

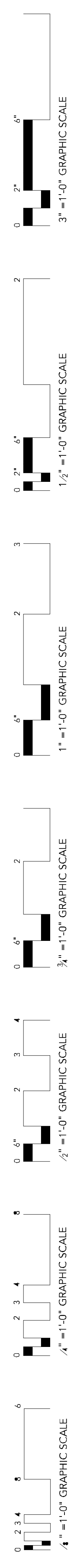

GENERAL NOTES:  
 A. CAP OPEN ENDS OF DUCTWORK WITH 1/4\"/>

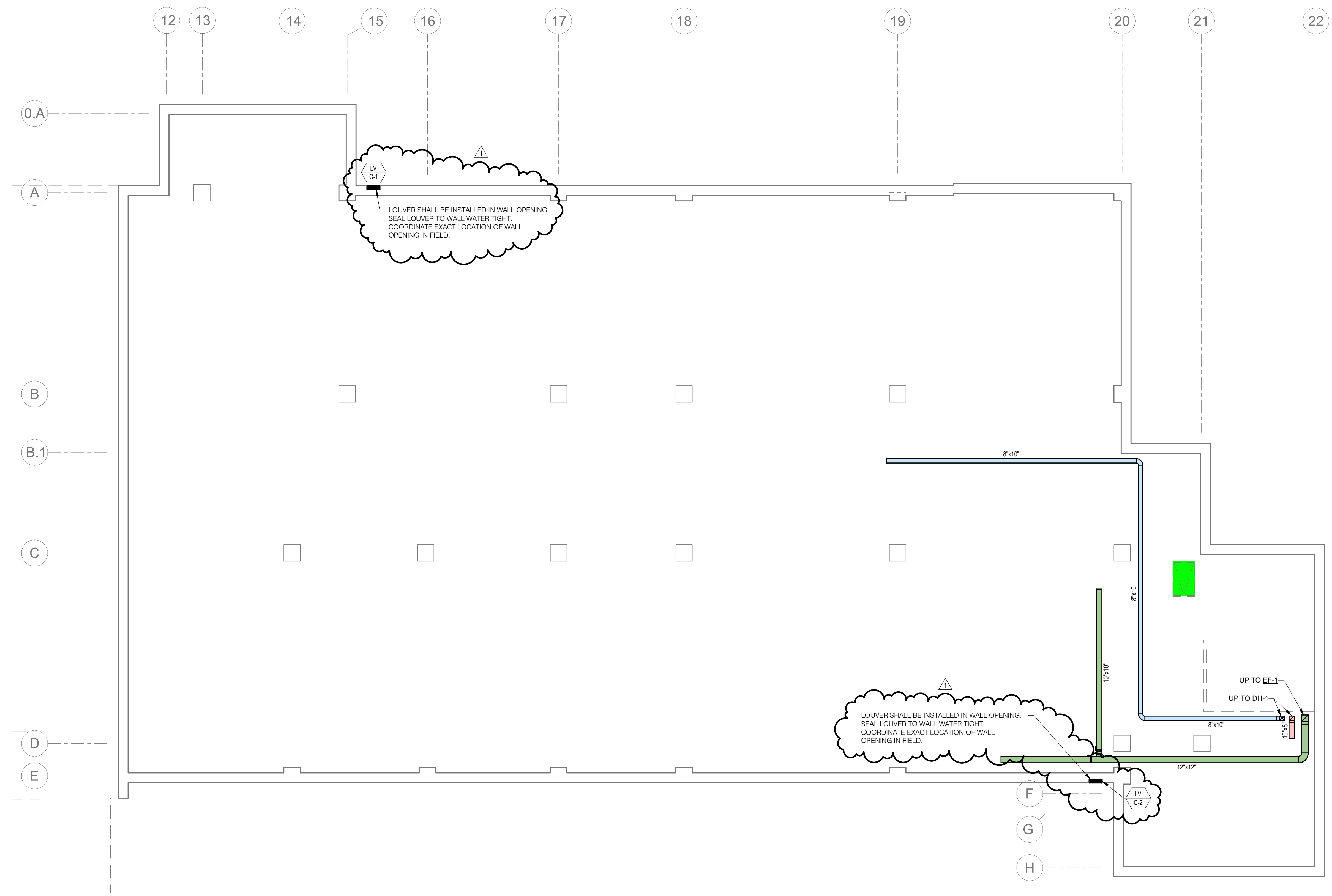

1 M100 OVERALL CRAWLSPACE HVAC FLOOR PLAN  
 1/8\"/>



661 Sunnybrook, Ste 140  
 Ridgeland, MS 39157  
 601 939 7717  
 deanandean.com

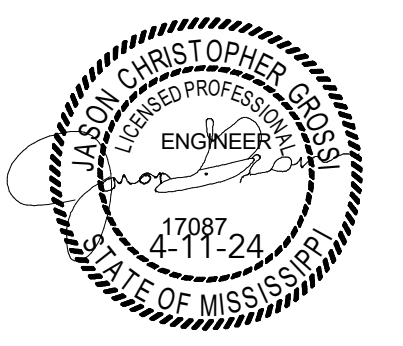

CONSTRUCTION DOCUMENTS

Project No.: 21041  
 Date: April 11, 2024  
 Drawn: CMM, GCC  
 Checked: JCG  
 Revisions: Addendum 3 - 05.13.2024

HEALTH SCIENCES COMPLEX -  
 (RANKIN CAMPUS) HINDS COMMUNITY COLLEGE  
 (COMMUNITY COLLEGE BOARD)  
 PEARL, MISSISSIPPI

Sheet Number:  
**M100**  
 OVERALL CRAWLSPACE  
 HVAC PLAN



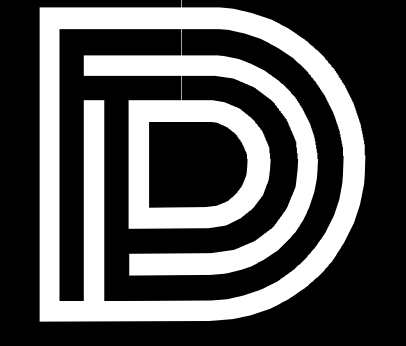

**DEAN**  
ARCHITECTURE  
E | D | I | R | A | N | T | O | U | R | E

661 Sunnybrook, Ste 140  
Ridgeland, MS 39157  
601 939 7717  
dean@dean.com



CONSTRUCTION  
DOCUMENTS

Project No.: 21041  
Date: April 11, 2024  
Drawn: CMM, GCC  
Checked: JCG  
Revisions:  
Addendum 3 - 05.13.2024

HEALTH SCIENCES COMPLEX -  
(RANKIN CAMPUS) HINDS COMMUNITY COLLEGE  
(COMMUNITY COLLEGE BOARD)  
PEARL, MISSISSIPPI

Sheet Number:

**M601**

HVAC SCHEDULES

**AIR COOLED CHILLER**

TAG	MANUFACTURER AND MODEL NO.	COMP. TYPE	CAP. (TONS)	REFER. TYPE	AMB. TEMP.	FULL LOAD EER	ARI IPLV	EVAPORATOR				ELECTRICAL				OPER. WT. (LBS)	REMARKS			
								DESIGN GPM	MINIMUM GPM	FLUID	EWT	LWT	PD(FT.)	F.F.	VOLT/Ø			MCA	MOCP	KW
CH 1	TRANE RTAF250	SCREW	227	513A	95.0	9.8	17.1	340	288	WATER	58	42	4.4	0.0001	460/3	487	600	278	14,000	FACTORY MOUNTED CIRCUIT BREAKER W/ 10K SCRR. CONVENIENCE OUTLET. FULL LENGTH ARCH. LOUVERED PANELS. LOW AMBIENT TO 0 DEG F. BACNET INTERFACE. VARIABLE SPEED SCREW COMPRESSORS. VARIABLE SPEED PERMANENT MAGNET MOTOR CONDENSER FANS (ALL FANS). UNLOADING TO 15% WITH CONSTANT 95 DEGREE AMBIENT. COMPRESSOR SERVICE VALVES. FULL 5 YEAR PARTS, LABOR, AND REFRIGERANT WARRANTY. BY MANUFACTURER. "SINGLE POINT POWER, (1) 120V/1PH CIRCUITS FOR EVAPORATOR FREEZE PROTECTION
CH 2	TRANE RTAF250	SCREW	227	513A	95.0	9.8	17.1	340	288	WATER	58	42	4.4	0.0001	460/3	487	600	278	14,000	FACTORY MOUNTED CIRCUIT BREAKER W/ 10K SCRR. FULL LENGTH ARCH. LOUVERED PANELS. LOW AMBIENT TO 0 DEG F. BACNET INTERFACE. VARIABLE SPEED SCREW COMPRESSORS. VARIABLE SPEED PERMANENT MAGNET MOTOR CONDENSER FANS (ALL FANS). UNLOADING TO 15% WITH CONSTANT 95 DEGREE AMBIENT. COMPRESSOR SERVICE VALVES. FULL 5 YEAR PARTS, LABOR, AND REFRIGERANT WARRANTY. "SINGLE POINT POWER, (1) 120V/1PH CIRCUITS FOR EVAPORATOR FREEZE PROTECTION
CH 3	TRANE RTAF250	SCREW	227	513A	95.0	9.8	17.1	340	288	WATER	58	42	4.4	0.0001	460/3	487	600	278	14,000	FACTORY MOUNTED CIRCUIT BREAKER W/ 10K SCRR. FULL LENGTH ARCH. LOUVERED PANELS. LOW AMBIENT TO 0 DEG F. BACNET INTERFACE. VARIABLE SPEED SCREW COMPRESSORS. VARIABLE SPEED PERMANENT MAGNET MOTOR CONDENSER FANS (ALL FANS). UNLOADING TO 15% WITH CONSTANT 95 DEGREE AMBIENT. COMPRESSOR SERVICE VALVES. FULL 5 YEAR PARTS, LABOR, AND REFRIGERANT WARRANTY. "SINGLE POINT POWER, (1) 120V/1PH CIRCUITS FOR EVAPORATOR FREEZE PROTECTION

**AIR COOLED CHILLER POWER CONNECTIONS**

TAG	DESCRIPTION	POWER WIRING	CONTROL & INTERLOCK WIRING	ELECTRICAL			REMARKS
				V/Ø	MCA	MOCP	
CH 1	SINGLE POINT POWER	DIV 26 ELECTRICAL	-	460/3	487	600	SINGLE POINT CONNECTION. FACTORY MOUNTED CIRCUIT BREAKER W/ 10K SCRR
	FREEZE PROTECTION	DIV 26 ELECTRICAL	-	120/1	--	15	SEPARATE CONNECTION FOR EVAPORATOR FREEZE PROTECTION.
CH 2	SINGLE POINT POWER	DIV 26 ELECTRICAL	-	460/3	487	600	SINGLE POINT CONNECTION. FACTORY MOUNTED CIRCUIT BREAKER W/ 10K SCRR
	FREEZE PROTECTION	DIV 26 ELECTRICAL	-	120/1	--	15	SEPARATE CONNECTION FOR EVAPORATOR FREEZE PROTECTION.
CH 3	SINGLE POINT POWER	DIV 26 ELECTRICAL	-	460/3	487	600	SINGLE POINT CONNECTION. FACTORY MOUNTED CIRCUIT BREAKER W/ 10K SCRR
	FREEZE PROTECTION	DIV 26 ELECTRICAL	-	120/1	--	15	SEPARATE CONNECTION FOR EVAPORATOR FREEZE PROTECTION.

**CONDENSING GAS FIRED HEATING BOILER SCHEDULE**

TAG	MANUFACTURER AND MODEL NO.	FUEL	CAPACITY (MBH)		MIN EFFICIENCY (%)	TURNDOWN	EWT	LWT	DESIGN GPM	MINIMUM GPM	BOILER DESIGN PRESSURE	PRESSURE DROP (FT)	ELECTRICAL		OPER. WT. (LBS)	REMARKS
			IN	OUT									AMPS	V/Ø		
B 1	LOCHINVAR FCB3000	NAT GAS	3000	2883	96	20:1	140	110	200	72	160 PSI	8	6.5	208/3	3600	FACTORY OUTDOOR VENT KIT, FACTORY GAS TRAIN, CONDENSATE NEUTRALIZATION KIT, O2 SENSOR, BACnet GATEWAY
B 2	LOCHINVAR FCB3000	NAT GAS	3000	2883	96	20:1	140	110	200	72	160 PSI	8	6.5	208/3	3600	FACTORY OUTDOOR VENT KIT, FACTORY GAS TRAIN, CONDENSATE NEUTRALIZATION KIT, O2 SENSOR, BACnet GATEWAY
B 3	LOCHINVAR FCB3000	NAT GAS	3000	2883	96	20:1	140	110	200	72	160 PSI	8	6.5	208/3	3600	FACTORY OUTDOOR VENT KIT, FACTORY GAS TRAIN, CONDENSATE NEUTRALIZATION KIT, O2 SENSOR, BACnet GATEWAY

**HEAT TRACE SCHEDULE**

TAG	MANUFACTURER	HEATING CABLE	CONTROLS	SERVES	PIPE SIZE	MAX LENGTH (FT)	ELECTRICAL			REMARKS
							VOLT/Ø	W/FT	MOCP	
HT 1	CHROMOLOX	SRL8-1CR	RTAS	CHWR	8"	200	208/1	6.88	20	ELECTRICAL CIRCUIT (BY DIVISION 23) TO BE GFI AND CONNECT TO RTAS INTEGRATED TEMPERATURE CONTROL. SPIRAL RUN. INSTALL RTAS WITH STAINLESS STEEL PIPE STRAP KIT, FIBERGLAS TAPE (FT-3) EVERY 10". PROVIDE ALL ENDS WITH RTES END SEAL KIT, PROVIDE CAUTION LABEL (CL-1) EVERY 10' IN A VISIBLE LOCATION. ANY SPLICES SHALL BE WITH SPLICE AND TEE KIT, PROVIDE WITH END SEAL.
HT 2	CHROMOLOX	SRL8-1CR	RTAS	CHWS	8"	200	208/1	6.88	20	ELECTRICAL CIRCUIT (BY DIVISION 23) TO BE GFI AND CONNECT TO RTAS INTEGRATED TEMPERATURE CONTROL. SPIRAL RUN. INSTALL RTAS WITH STAINLESS STEEL PIPE STRAP KIT, FIBERGLAS TAPE (FT-3) EVERY 10". PROVIDE ALL ENDS WITH RTES END SEAL KIT, PROVIDE CAUTION LABEL (CL-1) EVERY 10' IN A VISIBLE LOCATION. ANY SPLICES SHALL BE WITH SPLICE AND TEE KIT, PROVIDE WITH END SEAL.

**LINEAR SLOT DIFFUSERS SCHEDULE**

TAG	MANUFACTURER & MODEL NO.	NO. OF SLOTS	SLOT WIDTH (IN)	TOTAL WIDTH (IN)	BORDER TYPE	PATTERN	MOUNTING	PLENUM			MAX NC	REMARKS	
								NUMBER	LENGTH (IN)	INLET (IN.)			
LSD-1	PRICE CF	1	1.5	4.5	EF	JET THROW	CEILING TYPE C	1	48	8	CFP	25	SEE FLOOR PLAN FOR LENGTH OF SLOT. BLANK OFF UNUSED PORTION OF SLOT. FINISH TO BE SELECTED BY ARCH.
LSD-2	PRICE CF	1	1	4	EF	JET THROW	CEILING TYPE C	6	48	6	CFP	25	SEE FLOOR PLAN FOR LENGTH OF SLOT. BLANK OFF UNUSED PORTION OF SLOT. FINISH TO BE SELECTED BY ARCH.
LSD-3	PRICE CF	1	1	4	EF	JET THROW	CEILING TYPE C	2	48	6	CFP	25	SEE FLOOR PLAN FOR LENGTH OF SLOT. BLANK OFF UNUSED PORTION OF SLOT. FINISH TO BE SELECTED BY ARCH.
LSD-4	PRICE CF	1	2	9.5	EF	ADJUST.	CEILING TYPE C	5	48	8	CFP	25	SEE FLOOR PLAN FOR LENGTH OF SLOT. BLANK OFF UNUSED PORTION OF SLOT. FINISH TO BE SELECTED BY ARCH.

**VARIABLE FREQUENCY DRIVES (BY DIVISION 23C)**

TAG	SERVES	MANUFACTURER AND MODEL NO.	ELECTRICAL		REMARKS
			HP	VOLT/Ø	
VFD 1	CWP-1	YASKAWA HV600	15	460/3	NEMA 1 ENCLOSURE, WITH BYPASS, BACnet INTERFACE
VFD 2	CWP-2	YASKAWA HV600	15	460/3	NEMA 1 ENCLOSURE, WITH BYPASS, BACnet INTERFACE
VFD 3	CWP-3	YASKAWA HV600	15	460/3	NEMA 1 ENCLOSURE, WITH BYPASS, BACnet INTERFACE
VFD 4	HWP-1	YASKAWA HV600	15	460/3	NEMA 1 ENCLOSURE, WITH BYPASS, BACnet INTERFACE
VFD 5	HWP-2	YASKAWA HV600	15	460/3	NEMA 1 ENCLOSURE, WITH BYPASS, BACnet INTERFACE
VFD 6	HWP-3	YASKAWA HV600	15	460/3	NEMA 1 ENCLOSURE, WITH BYPASS, BACnet INTERFACE

**VIBRATION ISOLATION/SEISMIC RESTRAINTS**

EQUIPMENT TYPE	MANUFACTURER	SEISMIC DESIGN CATEGORY "SDC"	SEISMIC COMPONENT IMPORTANCE FACTOR	NOTES
MECHANICAL EQUIPMENT	VIBRO ACOUSTICS	B	1.5	1, 2
AIR-HANDLING UNITS	VIBRO ACOUSTICS	B	1.5	1, 2
VAV BOXES	VIBRO ACOUSTICS	B	1.5	1, 2
PUMPS	VIBRO ACOUSTICS	B	1.5	1, 2
FANS	VIBRO ACOUSTICS	B	1.5	1, 2
DUCTWORK	VIBRO ACOUSTICS	B	1.5	1, 2
PIPING	VIBRO ACOUSTICS	B	1.5	1, 2

NOTES:  
1. SEE SPECIFICATIONS FOR ADDITIONAL REQUIREMENTS.  
2. SEISMICALLY RATED FOR PROJECT CONDITIONS.  
3. ALL SEISMIC SHALL MEET ASCE 7-10.

**MISCELLANEOUS EQUIPMENT**

TAG	MANUFACTURER AND MODEL NO.	SERVING	DESCRIPTION	CAPACITY	DESIGN CONDITIONS FILL AND RELIEF PRESSURE	OPER. WT. (LBS)	REMARKS
ET 1	B&G B-300	HOT WATER	EXPANSION TANK	80 GAL	50 PSI FILL 100 PSI RELIEF	900	VERTICAL WITH BASE RING, ASME CONSTRUCTION, HEAVY-DUTY REPLACEABLE BLADDER, AUTOMATIC AIR VENT
ET 2	B&G B-200	CHILLED WATER	EXPANSION TANK	53 GAL	40 PSI FILL 100 PSI RELIEF	630	VERTICAL WITH BASE RING, ASME CONSTRUCTION, HEAVY-DUTY REPLACEABLE BLADDER, AUTOMATIC AIR VENT
AS 1	B&G SRS-6F	HOT WATER	AIR & DIRT SEPARATOR	700 GPM	N/A	530	FLANGED CONNECTIONS, ASME CERTIFIED, REMOVABLE LOWER HEAD, MANUAL BLOWDOWN VALVE
AS 2	B&G SRS-6F	CHILLED WATER	AIR & DIRT SEPARATOR	1000 GPM	N/A	1115	FLANGED CONNECTIONS, ASME CERTIFIED, REMOVABLE LOWER HEAD, MANUAL BLOWDOWN VALVE
CPF 1	WINGERT	HOT WATER	CHEMICAL POT FEEDER	5 GAL	N/A	125	WITH DRAIN PORT
CPF 2	WINGERT	CHILLED WATER	CHEMICAL POT FEEDER	5 GAL	N/A	125	WITH DRAIN PORT

**MISCELLANEOUS HVAC POWER, CONTROL AND INTERLOCK WIRING CONNECTIONS**

TAG	DESCRIPTION	POWER WIRING	CONTROL & INTERLOCK WIRING	ELECTRICAL	REMARKS
EMCS	BUILDING AUTOMATION SYSTEM BUILDING CONTROLLERS	DIV 23 EMCS	DIV 23 EMCS	120/1	NETWORK IT LAN DROP(S) AT REQUIRED EMCS LOCATIONS IS SPECIFIED UNDER DIVISION 23C EMCS.

**PUMPS**

TAG	MANUFACTURER AND MODEL NO.	SERVING	TYPE	GPM	HEAD	RPM	PUMP EFF (%)	MAX NPSHR	BHP	HP	V/Ø	OP WT. (LBS)	REMARKS
CHP 1	B&G 1531 3BD	CHILLED WATER	CLOSE COUPLED END SUCTION	500	75	1750	84	7.4	11	15	460/3	500	PREMIUM EFFICIENCY INVERTER DUTY MOTORS, GAUGE TAPS, HOUSING DRAINS
CHP 2	B&G 1531 3BD	CHILLED WATER	CLOSE COUPLED END SUCTION	500	75	1750	84	7.4	11	15	460/3	500	PREMIUM EFFICIENCY INVERTER DUTY MOTORS, GAUGE TAPS, HOUSING DRAINS
CHP 3	B&G 1531 3BD	CHILLED WATER	CLOSE COUPLED END SUCTION	500	75	1750	84	7.4	11	15	460/3	500	PREMIUM EFFICIENCY INVERTER DUTY MOTORS, GAUGE TAPS, HOUSING DRAINS
HWP 1	B&G 1531 2.5BB	HEATING WATER	CLOSE COUPLED END SUCTION	350	85	1720	79	6.5	9	15	460/3	400	PREMIUM EFFICIENCY INVERTER DUTY MOTORS, GAUGE TAPS, HOUSING DRAINS
HWP 2	B&G 1531 2.5BB	HEATING WATER	CLOSE COUPLED END SUCTION	350	85	1720	79	6.5	9	15	460/3	400	PREMIUM EFFICIENCY INVERTER DUTY MOTORS, GAUGE TAPS, HOUSING DRAINS
HWP 3	B&G 1531 2.5BB	HEATING WATER	CLOSE COUPLED END SUCTION	350	85	1720	79	6.5	9	15	460/3	400	PREMIUM EFFICIENCY INVERTER DUTY MOTORS, GAUGE TAPS, HOUSING DRAINS

**WALL LOUVER SCHEDULE**

TAG	MANUFACTURER & MODEL NO.	FUNCTION	CFM	MIN NET FREE AREA (SQ FT)	OVERALL SIZE (L X H)	DEPTH	MAX PD (IN.W.G.)	POWER V/Ø	REMARKS
LV C-1	RUSKIN ELF520DD	CRAWLSPACE VENTILATION	---	1.6	24x24	6	---	---	FLUOROPOLYMER FINISH IN COLOR SELECTED BY ARCHITECT, ALUMINUM INSECT SCREEN
LV C-2	RUSKIN ELF520DD	CRAWLSPACE VENTILATION	---	1.6	24x24	6	---	---	FLUOROPOLYMER FINISH IN COLOR SELECTED BY ARCHITECT, ALUMINUM INSECT SCREEN
LV 1-1	RUSKIN ELF520DD	OUTSIDE AIR AHU-1-1	2300	51.6	120x120	6	---	---	FLUOROPOLYMER FINISH IN COLOR SELECTED BY ARCHITECT, ALUMINUM BIRDSCREEN, BLANK OFF UNUSED PORTION OF LOUVER
LV 1-2	RUSKIN ELF520DD	OUTSIDE AIR AHU-1-2	2700	51.6	120x120	6	---	---	FLUOROPOLYMER FINISH IN COLOR SELECTED BY ARCHITECT, ALUMINUM BIRDSCREEN, BLANK OFF UNUSED PORTION OF LOUVER
LV 2-1	RUSKIN ELF520DD	OUTSIDE AIR AHU-2-1	2100	51.6	120x120	6	---	---	FLUOROPOLYMER FINISH IN COLOR SELECTED BY ARCHITECT, ALUMINUM BIRDSCREEN, BLANK OFF UNUSED PORTION OF LOUVER
LV 2-2	RUSKIN ELF520DD	OUTSIDE AIR AHU-2-2	2900	51.6	120x120	6	---	---	FLUOROPOLYMER FINISH IN COLOR SELECTED BY ARCHITECT, ALUMINUM BIRDSCREEN, BLANK OFF UNUSED PORTION OF LOUVER
LV 3-1	RUSKIN ELF520DD	OUTSIDE AIR AHU-3-1	2200	51.6	120x120	6	---	---	FLUOROPOLYMER FINISH IN COLOR SELECTED BY ARCHITECT, ALUMINUM BIRDSCREEN, BLANK OFF UNUSED PORTION OF LOUVER
LV 3-2	RUSKIN ELF520DD	OUTSIDE AIR AHU-3-2	3100	51.6	120x120	6	---	---	FLUOROPOLYMER FINISH IN COLOR SELECTED BY ARCHITECT, ALUMINUM BIRDSCREEN, BLANK OFF UNUSED PORTION OF LOUVER
LV 4-1	RUSKIN ELF520DD	OUTSIDE AIR AHU-4-1	2200	51.6	120x120	6	---	---	FLUOROPOLYMER FINISH IN COLOR SELECTED BY ARCHITECT, ALUMINUM BIRDSCREEN, BLANK OFF UNUSED PORTION OF LOUVER
LV 4-2	RUSKIN ELF520DD	OUTSIDE AIR AHU-4-2	3100	51.6	120x120	6	---	---	FLUOROPOLYMER FINISH IN COLOR SELECTED BY ARCHITECT, ALUMINUM BIRDSCREEN, BLANK OFF UNUSED PORTION OF LOUVER

**AIR DISTRIBUTION DEVICE SCHEDULE**

TAG	TYPE	MANUFACTURER & MODEL NO.	NECK SIZE	FACE SIZE	ESTIMATED COUNT	REMARKS
A1	CEILING MOUNTED SUPPLY AIR DEVICE	PRICE SPD	6"Ø	12x12"	11	PROVIDE ALL SURFACE MOUNTED GRILLES WITH PLASTER FRAME MOUNT (PRICE SPF).
B6	CEILING MOUNTED SUPPLY AIR DEVICE	PRICE SPD	6"Ø	24x24"	174	PROVIDE ALL SURFACE MOUNTED GRILLES WITH PLASTER FRAME MOUNT (PRICE SPF).
B8	CEILING MOUNTED SUPPLY AIR DEVICE	PRICE SPD	6"Ø	24x24"	309	PROVIDE ALL SURFACE MOUNTED GRILLES WITH PLASTER FRAME MOUNT (PRICE SPF).
B10	CEILING MOUNTED SUPPLY AIR DEVICE	PRICE SPD	10"Ø	24x24"	209	PROVIDE ALL SURFACE MOUNTED GRILLES WITH PLASTER FRAME MOUNT (PRICE SPF).
B12	CEILING MOUNTED SUPPLY AIR DEVICE	PRICE SPD	12"Ø	24x24"	2	PROVIDE ALL SURFACE MOUNTED GRILLES WITH PLASTER FRAME MOUNT (PRICE SPF).
C1	SIDEWALL MOUNTED SUPPLY AIR DEVICE	PRICE 520D	8x6"	10x8"	4	FACE SIZE TO BE NECK SIZE PLUS 2". PROVIDE WITH TYPE "A" EXTERNAL SCREW. PROVIDE WITH OPPOSED BLADE VOLUME DAMPER.
C2	SIDEWALL MOUNTED SUPPLY AIR DEVICE	PRICE 520D	12x6"	14x8"	17	FACE SIZE TO BE NECK SIZE PLUS 2". PROVIDE WITH TYPE "A" EXTERNAL SCREW. PROVIDE WITH OPPOSED BLADE VOLUME DAMPER.
C3	SIDEWALL MOUNTED SUPPLY AIR DEVICE	PRICE 520D	12x8"	14x10"	92	FACE SIZE TO BE NECK SIZE PLUS 2". PROVIDE WITH TYPE "A" EXTERNAL SCREW. PROVIDE WITH OPPOSED BLADE VOLUME DAMPER.
D1	CEILING MOUNTED RETURN AIR DEVICE	PRICE 80	10x22"	12x24"	208	PROVIDE ALL SURFACE MOUNTED GRILLES WITH SCREW HOLES.
D2	CEILING MOUNTED RETURN AIR DEVICE	PRICE 80	22x22"	24x24"	55	PROVIDE ALL SURFACE MOUNTED GRILLES WITH SCREW HOLES.
E1	SIDEWALL MOUNTED RETURN AIR DEVICE	PRICE 530L	8x6"	10x8"	4	FACE SIZE TO BE NECK SIZE PLUS 2". PROVIDE WITH TYPE "A" EXTERNAL SCREW. PROVIDE WITH OPPOSED BLADE VOLUME DAMPER.
E2	SIDEWALL MOUNTED RETURN AIR DEVICE	PRICE 530L	12x6"	14x8"	1	FACE SIZE TO BE NECK SIZE PLUS 2". PROVIDE WITH TYPE "A" EXTERNAL SCREW. PROVIDE WITH OPPOSED BLADE VOLUME DAMPER.
E3	SIDEWALL MOUNTED RETURN AIR DEVICE	PRICE 530L	12x8"	14x10"	2	FACE SIZE TO BE NECK SIZE PLUS 2". PROVIDE WITH TYPE "A" EXTERNAL SCREW. PROVIDE WITH OPPOSED BLADE VOLUME DAMPER.
F6	CEILING MOUNTED EXHAUST AIR DEVICE	PRICE 80	6"Ø / 10x10"	12x12"	11	PROVIDE SURFACE MOUNT WITH TYPE "A" EXTERNAL SCREW. PROVIDE MINIMUM 3" SQUARE TO ROUND ON TOP OF GRILLE.
F8	CEILING MOUNTED EXHAUST AIR DEVICE	PRICE 80	8"Ø / 10x10"	12x12"	1	PROVIDE SURFACE MOUNT WITH TYPE "A" EXTERNAL SCREW. PROVIDE MINIMUM 3" SQUARE TO ROUND ON TOP OF GRILLE.
F10	CEILING MOUNTED EXHAUST AIR DEVICE	PRICE 80	10"Ø / 10x10"	12x12"	9	PROVIDE SURFACE MOUNT WITH TYPE "A" EXTERNAL SCREW. PROVIDE MINIMUM 3" SQUARE TO ROUND ON TOP OF GRILLE.
F12	CEILING MOUNTED EXHAUST AIR DEVICE	PRICE 80	12"Ø / 10x10"	12x12"	3	PROVIDE SURFACE MOUNT WITH TYPE "A" EXTERNAL SCREW. PROVIDE MINIMUM 3" SQUARE TO ROUND ON TOP OF GRILLE.
G1	DUCT MOUNTED SUPPLY AIR DEVICE	PRICE SDGE	1			

# The Power Source, PLLC

Consulting Engineers

305 Hwy 51  
Ridgeland, MS 39157

Telephone: (601) 605-4820

## Addendum #3

**Date:** 5/13/2024

**To:** Brad Heath, Dean Architecture

**From:** Chris Green, PE

**Subject:** Hinds Community College – Health Science Center

TPS PN: 23040

The following item shall be incorporated into the bid documents:

Refer to drawings.

Item # 1 – Sheet E007 – Modified electrical panel schedules.

Sincerely,

A handwritten signature in black ink, appearing to read "Chris Green", written in a cursive style.

Chris Green, PE  
The Power Source, PLLC

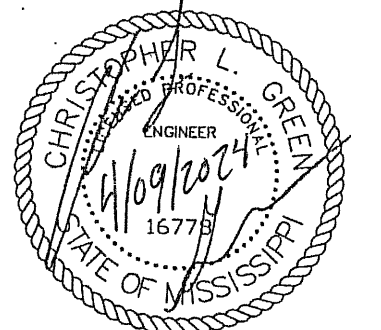

CONSTRUCTION DOCUMENTS

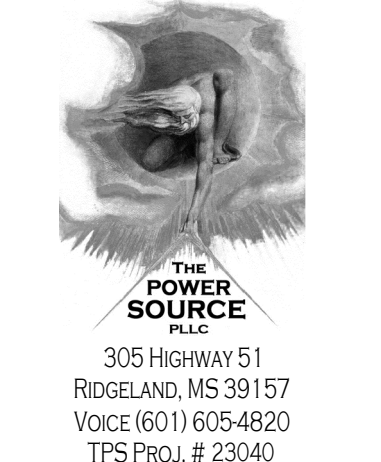

Project No. 21041  
Date: APRIL 11, 2024  
Drawn: CTB  
Checked: CLC  
Revisions: MAY 13, 2024

HEALTH SCIENCES COMPLEX -  
(RANKIN CAMPUS) HINDS COMMUNITY  
COLLEGE (COMMUNITY COLLEGE BOARD)  
PEARL, MISSISSIPPI

Sheet Number:

**E007**

PANEL SCHEDULES

PANEL		LOCATION: ELECTRICAL ROOM 1010		LUG LOCATION: BOTTOM FEED		LUG LOCATION: MAIN BUS ONLY		PANELBOARD AIC RATING (A)	
HLS1S		VOLT: 480Y/277V, 3Ø, 4W		MAIN BUS MOUNTING: SURFACE		MAIN BUS MOUNTING: SURFACE		25,000	
CIRCUIT NO.	BREAKER	DESCRIPTION	A	B	C	DESCRIPTION	A	B	C
1	20	LTS - LOBBY 1000, CORR 1009, LAB 1509	2.0	2.1		LTS - BLDG 2013, CORR 2016, LOB 2000, CORR 2010	20	1	2
3	20	LTS - LOBBY 3000, CORR 3014, CLASS 2801	1.8	0.0			3	1	4
5	20	SPACE							6
7	20	SPACE	0.0	0.0					8
9	20	SPACE	0.0	0.0					10
11	20	SPACE	0.0	0.0					12
13	20	SPACE	0.0	0.0					14
15	20	SPACE	0.0	0.0					16
17	20	SPACE	0.0	0.0					18
19	20	SPACE	0.0	0.0					20
21	20	SPACE	0.0	0.0					22
23	20	SPACE	0.0	0.0					24
25	20	SPACE	0.0	0.0					26
27	20	SPACE	0.0	0.0					28
29	20	SPACE	0.0	0.0					30
31	20	SPACE	0.0	0.0					32
33	60	3	0.0	0.0					34
35	-	-	0.0	0.0					36
37	-	-	0.0	0.5					38
39	-	-	0.0	0.5					40
41	-	-	0.0	0.5					42
TOTAL			4.6	2.3					42

PANEL		LOCATION: ELECTRICAL ROOM 4001		LUG LOCATION: BOTTOM FEED		LUG LOCATION: MAIN BUS ONLY		PANELBOARD AIC RATING (A)	
HAAN		VOLT: 480Y/277V, 3Ø, 4W		MAIN BUS MOUNTING: SURFACE		MAIN BUS MOUNTING: SURFACE		35,000	
CIRCUIT NO.	BREAKER	DESCRIPTION	A	B	C	DESCRIPTION	A	B	C
1	20	LTS - SHELL SPACE	0.4	19.8		AHU-2	110	3	2
3	20	1							4
5	110	3				AHU-1			6
7	-	-	19.8	0.0		SPACE			8
9	-	-	19.8	0.0		SPACE			10
11	-	-	0.0	0.0		SPACE			12
13	-	-	0.0	0.0		SPACE			14
15	-	-	0.0	0.0		SPACE			16
17	-	-	0.0	0.0		SPACE			18
19	-	-	0.0	0.0		SPACE			20
21	-	-	0.0	0.0		SPACE			22
23	-	-	0.0	0.0		SPACE			24
25	-	-	0.0	0.0		SPACE			26
27	-	-	0.0	0.0		SPACE			28
29	-	-	0.0	0.0		SPACE			30
31	-	-	0.0	0.0		SPACE			32
33	-	-	0.0	0.0		SPACE			34
35	-	-	0.0	0.0		SPACE			36
37	-	-	0.0	0.0		SPACE			38
39	-	-	0.0	0.0		SPACE			40
41	-	-	0.0	0.0		SPACE			42
43	-	-	0.0	0.0		SPACE			44
45	-	-	0.0	0.0		SPACE			46
47	-	-	0.0	0.0		SPACE			48
49	30	3	0.0	3.1		PANEL "LIAN"	110	3	50
51	-	-	0.0	3.1					52
53	-	-	43.1	42.7	41.1				54
TOTAL			43.1	42.7	41.1				54

PANEL		LOCATION: ELECTRICAL ROOM 0002		LUG LOCATION: BOTTOM FEED		LUG LOCATION: MAIN BUS ONLY		PANELBOARD AIC RATING (A)	
SWBD		VOLT: 480Y/277V, 3Ø, 4W		2500A MAIN BREAKER 100% LBS RATED SURFACE		MAIN BUS MOUNTING: SURFACE		65,000	
CIRCUIT NO.	BREAKER	DESCRIPTION	A	B	C	DESCRIPTION	A	B	C
1	225	3	56.4	56.3		HTAS	225	3	2
3	-	-							4
5	-	-							6
7	400	3	60.1	39.8		H2AS	225	3	8
9	-	-							10
11	-	-							12
13	400	3	90.8	39.8		H3AS	225	3	14
15	-	-							16
17	-	-							18
19	400	3	43.1	0.0		FUTURE HAAS	225	3	20
21	-	-							22
23	-	-							24
25	60	3	4.5	114.7		CH-2	800	3	26
27	-	-							28
29	-	-							30
31	600	3	114.7	114.7		CH-3	600	3	32
33	-	-							34
35	-	-							36
37	600	3	0.0	0.0		SPARE	225	3	38
39	-	-							40
41	-	-							42
43	225	3	55.7	0.0		SPARE	225	3	44
45	-	-							46
47	-	-							48
49	60	3	0.0	0.0		SPARE	225	3	50
51	-	-							52
53	-	-							54
TOTAL			789.5	636.7	0.0	0.0			54

\*BASE BID SHALL BE MAIN BREAKER. ALTERNATE #1 SHALL BE MAIN LUGS ONLY.

PANEL		LOCATION: ELECTRICAL ROOM 1011		LUG LOCATION: BOTTOM FEED		LUG LOCATION: MAIN BUS ONLY		PANELBOARD AIC RATING (A)	
H1AN		VOLT: 480Y/277V, 3Ø, 4W		225A		MAIN LUGS ONLY SURFACE		42,000	
CIRCUIT NO.	BREAKER	DESCRIPTION	A	B	C	DESCRIPTION	A	B	C
1	20	LTS - FILE STOR 1110 ADMIN ASSIST 1201	2.8	2.4		LTS - EMS CLASS 1000, EMS LAB 1404	20	1	2
3	20	LTS - CONTROL 1313, SIM 1310, STOR 1323	2.9	2.4		LTS - CORR 1012, 1019, MEN 1019, WOMEN 1014	20	1	4
5	20	LTS - CRAWL SPACE				LTS - ELEC 0002	20	1	6
7	20	LTS - PARKING LOT	1.9	0.0		SPACE	20	1	8
9	20	LTS - PARKING LOT	1.0	0.2		LTS - SERVICE YARD	20	1	10
11	20	LTS - EXTERIOR	0.5	0.7		LTS - 3RD FLOOR LOBBY	20	1	12
13	20	LTS - EXTERIOR	0.5	2.7		SPACE	15	3	14
15	20	LTS - EXISTING STREET LIGHTS	0.0	2.7		SPACE			16
17	20	1							18
19	20	1							20
21	20	1							22
23	40	3	0.0	4.2		AC-1	30	3	24
25	-	-							26
27	-	-				SPACE	20	3	28
29	40	3	0.0	0.0		SPACE			30
31	-	-							32
33	-	-							34
35	40	3	0.0	19.8		AHU 1-1	110	3	36
37	-	-							38
39	-	-							40
41	-	-				LTS - SIGN	20	1	42
43	-	-							44
45	-	-				SPACE			46
47	-	-				SPACE			48
49	30	3	0.0	22.0		SPACE	110	3	50
51	-	-				PANEL "LIAN"			52
53	-	-							54
TOTAL			56.4	62.6	0.0	17.8			54

PANEL		LOCATION: ELECTRICAL ROOM 1011		LUG LOCATION: BOTTOM FEED		LUG LOCATION: MAIN BUS ONLY		PANELBOARD AIC RATING (A)	
H1BN		VOLT: 480Y/277V, 3Ø, 4W		225A		MAIN LUGS ONLY SURFACE		65,000	
CIRCUIT NO.	BREAKER	DESCRIPTION	A	B	C	DESCRIPTION	A	B	C
1	40	3	5.8	5.8		HWP-1	40	3	2
3	-	-							4
5	-	-							6
7	40	3	5.8	5.8		HWP-2	40	3	8
9	-	-							10
11	-	-							12
13	40	3	5.8	5.8		HWP-3	40	3	14
15	-	-							16
17	-	-							18
19	40	3	0.0	0.0		SPACE	20	3	20
21	-	-							22
23	-	-				SPACE			24
25	-	-				SPACE			26
27	-	-				SPACE			28
29	-	-				SPACE			30
31	-	-				SPACE			32
33	-	-				SPACE			34
35	-	-				SPACE			36
37	-	-				SPACE			38
39	-	-				SPACE			40
41	-	-				SPACE			42
43	-	-				SPACE			44
45	-	-				SPACE			46
47	-	-				SPACE			48
49	-	-				SPACE			50
51	-	-				PANEL "L1BN"	110	3	52
53	-	-							54
TOTAL			55.7	56.8	57.4				54

PANEL		LOCATION: ELECTRICAL ROOM 1018		LUG LOCATION: BOTTOM FEED		LUG LOCATION: MAIN BUS ONLY		PANELBOARD AIC RATING (A)	